



## The Hatteras-34 Sport Cruiser pleases wives, too

In planning the Hatteras-34 Sport Cruiser, J. B. Hargrave, marine architect, set out to design a boat that would please husband and wife.

He has succeeded to a remarkable degree. The Hatteras-34 is a fine yacht which can be converted into an ideal sport-fisherman.

The Sport Cruiser is a joy for the mate. Boatkeeping is easier than housekeeping when you have vinyl floors, plastic surfaces and upholstery materials that wipe clean with a cloth. Meal-making is fun in the compact, efficient galley, kitchen-gearred for sea-going meals. So complete in every detail, there's even a full 10-foot electric refrigerator . . . and electric stove . . . two 110-volt outlets, stainless steel sink with hot and cold running water . . . dish and glass racks and space galore in three drawers, storage cabinet, and even beneath the steps to deck house.

The Master Stateroom is forward . . . offers both privacy and comfort . . . has two bunks with polyfoam mattresses . . . spacious drawers and large storage space under each bunk . . . also full length locker.



This sleek beauty can scamper through water at speeds expert skiers would love; or cruise smoothly (with twin engines) at speeds of 25 miles an hour at 3000 R.P.M.



The optional lounge converts to full-size upper and lower berths. The dinette converts to sleep two. Curtains provide privacy.



The deckhouse is an all-purpose family room. Weatherproof safety glass on four sides creates an airy atmosphere you can enjoy, even in bad weather, without feeling closed in.

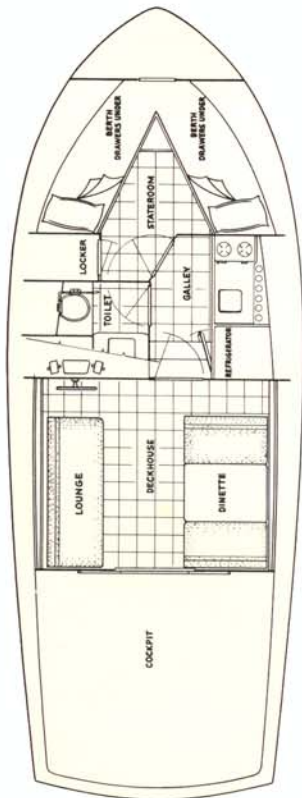

The efficient galley has either a three burner electric stove with oven or a two burner electric stove and a 10 cu. ft. refrigerator. Behind the stove and stainless steel sink, which has hot and cold pressure water, is sliding-door storage space for china and galley gear.



The Matheras-34 has a full size shower with hot and cold running water, wash-basin, storage cabinet, Medicine cabinet, mirror and good lighting. Large size hanging locker, two 110-volt outlets.

