



# New 34 foot Hatteras Deluxe Sportfisherman

The Deluxe Sportfisherman is a modification of the 34 Sports Cruiser to fulfill the discriminating requirements of the blue-water angler.

Incorporated in the Deluxe Sportfisherman: a streamlined bow rail; a curved sectional lounge on the port side of the deckhouse and a bar with an automatic ice machine on the starboard side at the chart deck bulkhead; a shower, hot water heater, water pressure system, 3-burner stove with oven; muffler; as well as cockpit controls.



Catch the big ones with a Hatteras.

Plenty of room for cocktails (with the bar and Ice Maker) or dining with easy access to the galley area.



Arrive early and return quickly to fishing grounds.

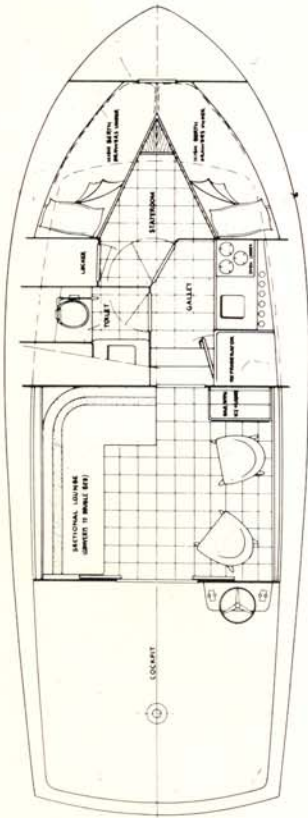

The efficient galley has a three burner electric stove with oven and a 10 cu. ft. refrigerator. Behind the stove and stainless steel sink, which has hot and cold pressure water, is sliding-door storage space for china and galley gear.



After a hard day's fishing, the bow stateroom provides solid comfort and privacy. Bunks with polyfoam mattresses invite relaxation. Two drawers and a locker under each bunk, and a full hanging locker provide ample storage space.

