



Hatteras 34

34 FEET OF

Blue Water Beauty

ANOTHER PRODUCTION-BUILT FIBERGLASS HATTERAS CRUISER . . . FINEST IN HER CLASS

ANOTHER ADVANCEMENT IN BOAT-DESIGN

...and the upkeep is low!

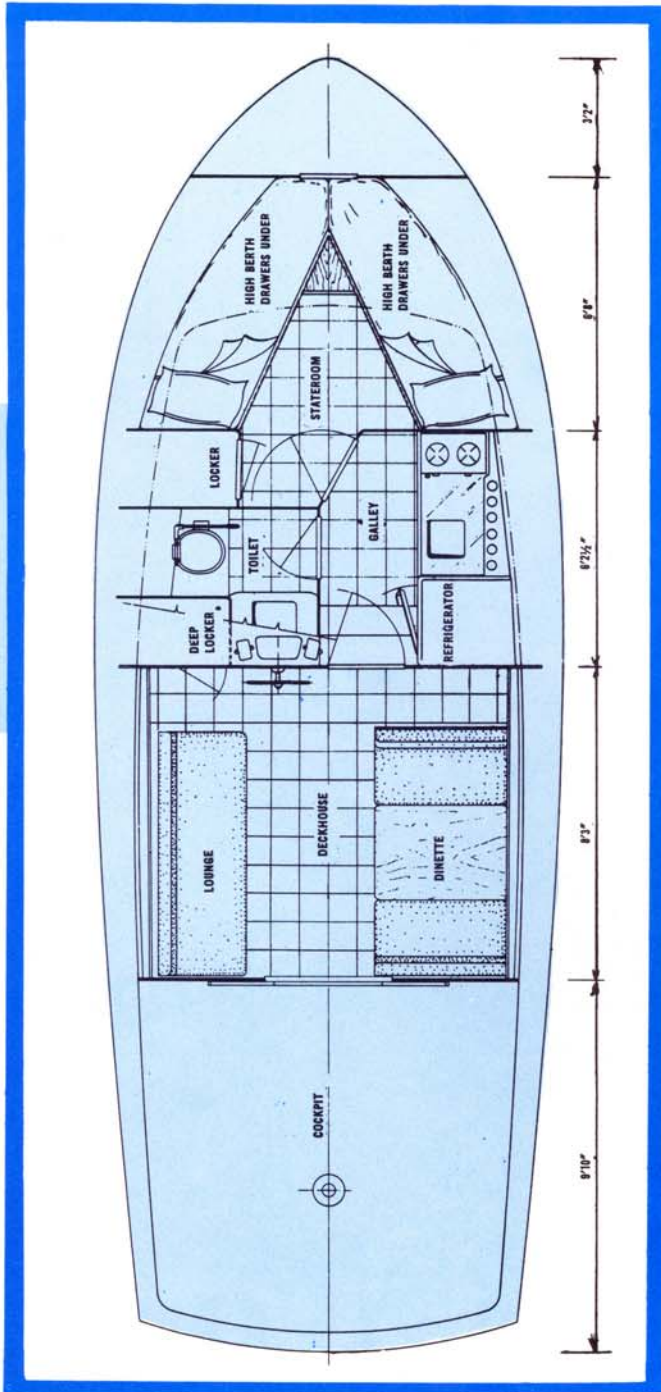

The makers of the famous "Hatteras-41" introduce a sleek, rugged sister-ship—the all-new "Hatteras-34"... first production-built fiberglass cruiser in the popular 34-foot class.

Already the "Hatteras-41" has made boating history... for her minimum maintenance... her swift, stable offshore performance... her sleek good looks... her luxurious cruising and fishing facilities.

Now yachtsmen who require all these boating extras—plus the maneuverability of a trim 34-footer—find them all in this sturdy fiberglass beauty.

She's easy to handle! She's dry! She's fast! And thanks to her all fiberglass hull, topsides and component parts, maintenance cost is less.

THE SLEEK LINES of the Hatteras hull represent a great step forward in boat design... and in hull construction. One-piece molded laminated fiberglass hull and fiberglass superstructure mean a stronger, dryer boat. And the use of fiberglass—strongest material pound for pound—allows a new and highly efficient hull design not obtainable with traditional materials. This gives the Hatteras-34 greater safety... greater speed in rough offshore waters... remarkable freedom from yawing and pounding. Yet the molded construction, with the elimination of bulky beams, ribs and frames, provides new spaciousness below... offers roominess and comfort usually found only in larger yachts.

The Hatteras-34 brings you safety and stability... enjoyment and excitement never before enjoyed in handling a boat such as this, plus the wonderful feeling that your maintenance worries are reduced to a minimum.

Sleeps 6 • LOA 34 ft. 2 in. • Beam 12 ft. 6 in. • Draft 36 in. •
Weight 11 000 lbs. • Speeds to 40 MPH with twin 280 HP engines
• 6 ft. 2 in. headroom • Dual or single controls • Fly bridge
See specification sheet for options.



LOOK . . . at the breathtaking beauty of the clean, sleek bow line. It can cut the water at speeds to 40 MPH . . . and stays steady, too! You can cruise at 25 to 32 miles an hour depending on engines selected. Easy to handle, also!

More boat... More beauty... More carefree cruising

LOOK . . . at the spacious comfortable cockpit . . . room to walk around . . . uncluttered, plenty of space for fishing in the deep; or just for cruising in the sun; to enjoy sociable loafing. The vinyl floor covering is easy to keep clean.





By the Builders of the
Famous Hatteras 41

OFFSHORE PERFORMANCE

Designed for the true boating enthusiast, the Hatteras-34 has been painstakingly tested and retested for dependable rugged-duty, offshore performance. Seaworthy and safe. Laminated fiberglass hull withstands shocks better. Also excellent on large lakes and large rivers. High-visibility fly bridge and spacious uncluttered cockpit are ideal for any form of boating.



CRUISING LUXURY

Ideal for luxurious cruising too! and loafing room galore! Sunbathe in the cockpit, or relax in comfort below. Sleeps six with upper-lower lounge, dinette and master stateroom. Practical, yet warm and beautiful interiors, with storage space a-plenty. Hatteras-34 comes as sedan or sport-cruiser. Designed to give you a smooth dry ride even in heavy seas.

LOW-COST MAINTENANCE

Give excessive maintenance cost and worries the deep six! No rot, no rust, no fastenings to work loose, no calking, no sanding, no continuous painting! Simply wash and wipe to keep in sparkling condition. Paint if you like. Marine borers can't touch it. You save time, money and labor, and are blue-water bound while most others are still fitting-out!



you have an **APPOINTMENT with PLEASURE**

Every detail, every option of the Hatteras-34 was designed for your pleasure afloat! Has 6 ft. 2 in. headroom . . . Lounge converts into comfortable upper and lower berths. Dinette converts handily to sleep two. Mattresses are poly-foam.

Floors are covered with easy-to-clean vinyl; windows are weather-proof safety glass.

"Decorator-design" is standard equipment on Hatteras yacht interiors . . . crafted in famous High

Point, North Carolina, the center of America's high-style furniture industry.

All of this, because the Hatteras-34 is production-built, is competitively priced . . . allowing you to enjoy your "appointment with pleasure," on the most modern 34-footer afloat, for what you'd expect to pay for a lesser boat.

HATTERAS YACHT COMPANY • HIGH POINT, NORTH CAROLINA

Galley is kitchen-engineered for easy cooking and clean-up . . . ice-box . . . stove . . . stainless steel sink . . . plenty of storage space. Dish and glass racks. Perfect for a snack or a sea-going stew!

Forward—the master stateroom offers privacy and comfort. Full-length lockers. Drawers a-plenty. All available space has been put to useful purpose.

Well planned lavatory has wash basin, (cabinet beneath) running water, medicine cabinet and mirror, ample lighting, toilet and full-sized locker.



DEEP DOWN QUALITY POINTS...

that make a Hatteras-34 a pleasure to own and operate, are shown by these photos, taken just before the decks are installed. Experienced yachtsmen will quickly recognize the excellency of the Hatteras construction and installation.

Seamless laminated fiberglass hull made of woven glass fibers bonded with miracle resins to make it the strongest boat material.

Rudder Pad reinforced with extra layers of fiberglass.

Deck Shelf bonded to hull with life time fiberglass.

Marine Plywood water-tight Bulkheads coated with life time resins.

Laminated Fiberglass Longitudinal Stringers molded into hull.

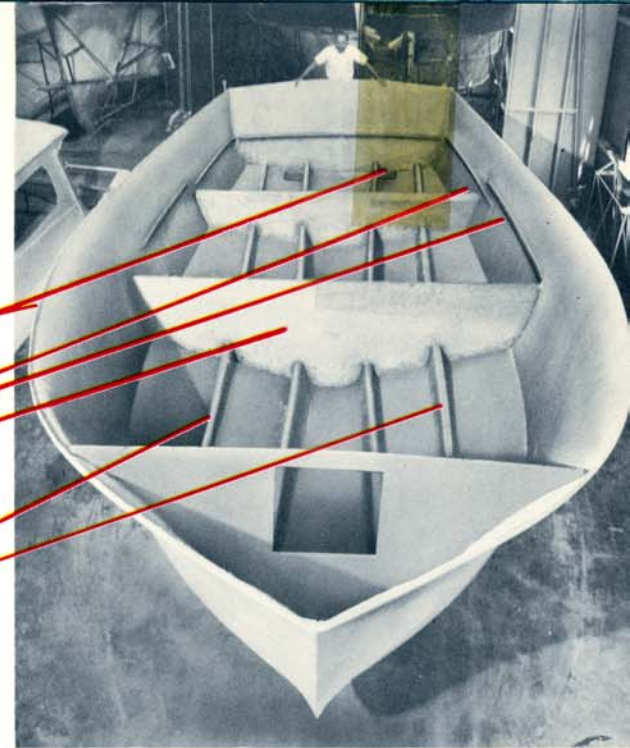

POWER TO PLEASE your choice of 185 to 280 H. P. gas engines with diesel power optional.

All Wiring is color and number coded for easy identification and easy lower cost maintenance.

Engine Mounts on fiberglass longitudinal stringers.

Bronze Exhaust "Wye's."

Molded in Live Bait Well (optional).

Fiberglass Exhaust Stacks (no rust, corrosion or electrolysis).

Fuel Tank Filler Pipe.

Life time fiberglass Fuel Tanks (100 gal. each) no rust, no welds, no leaks.

Strut Pad of fiberglass.

Mufflers (optional equipment).

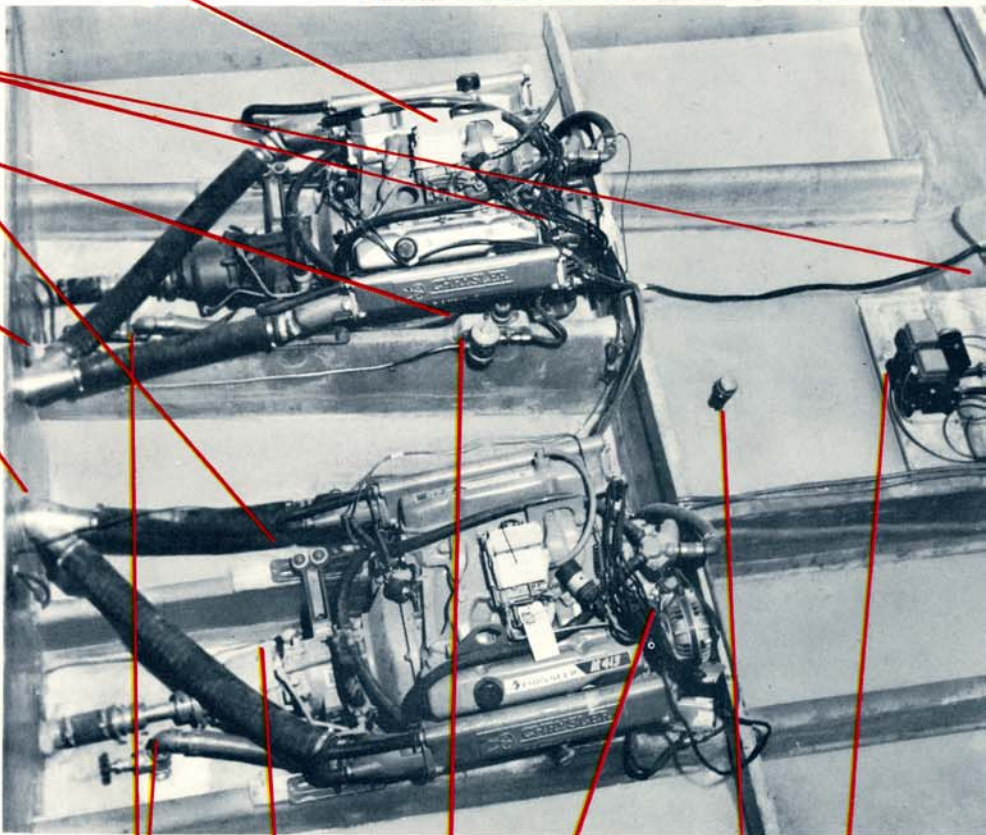

Engine Intake Sea Valve (all below water line through-hull fittings have sea valves as standard equipment).

Heavy Duty Fuel Filter (standard equipment).

Fiberglass fresh water tank and filler spout (70 gal.).

Hydraulic Transmission.

35 amp alternator keeps batteries charged.

Fresh water pressure system (Standard).

Fuel Cross Feed Valve.

Approved Fuel Shut Off.

Hydraulic Steering Ram.

Bronze Rudder Tie Bar.

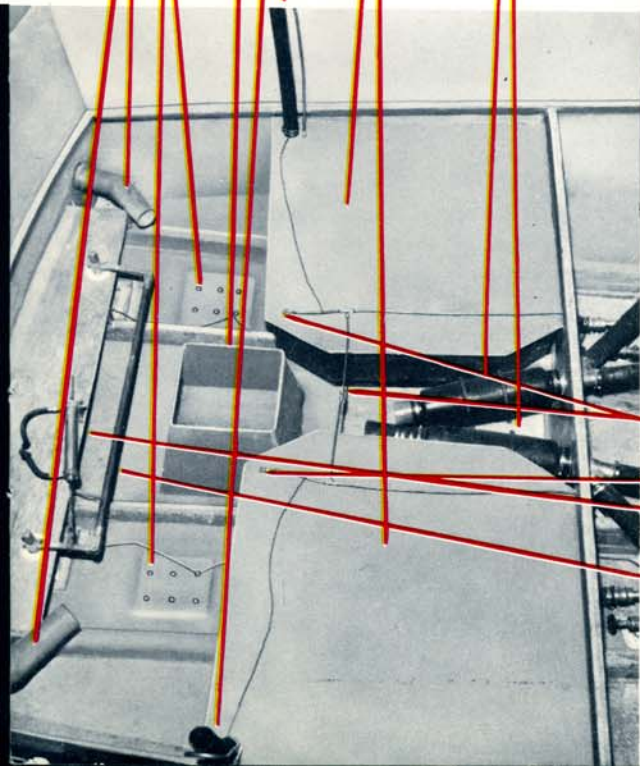

All speeds shown herein attained over certified course, under favorable conditions, or are estimated and not guaranteed. The right is reserved to make changes at any time without notice in prices and specifications.



Also producers of the Famous HATTERAS-41 . . . first large fiberglass production-built power cruiser, with More of everything *except* maintenance.



**. . . The Carefully Crafted Fiberglass 34-foot Power Cruiser
Finest in Her Class**