

Hatteras

40 DOUBLE CABIN

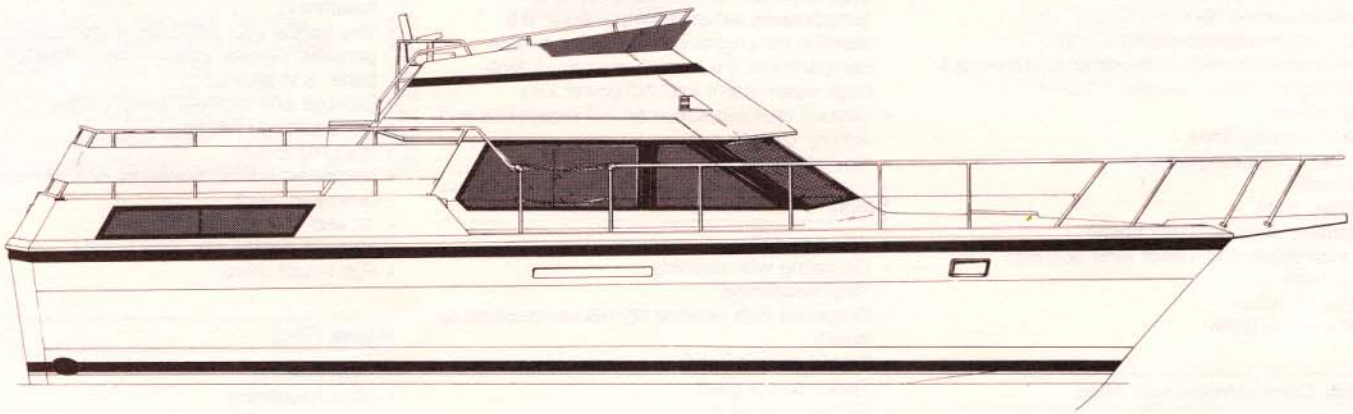

40 DOUBLE CABIN^(A) Specifications

Length Overall	40'10"	12.5 m	Weight Displacement	30,000 Lbs	13,608 kg
Beam	13'7"	4.1 m	Overhead Obstruction Clearance Required		
Draft	2'9"	0.8 m	To Top of Flying Bridge		
Freeboard — Forward	5'2"	1.6 m	Windshield Handrail	12'9"	3.9 m
Freeboard — Aft	4'4"	1.3 m	To Top of Optional Radar Arch	15'2"	4.6 m
Headroom Most Areas	6'5"	2.0 m	Twin 350 Crusader Gasoline Engines		
Fresh Water Capacity	110 Gals	417 ltr	Twin CAT 3208TA Diesel Engines		
Fuel Capacity	350 Gals	1,249 ltr			

STANDARD EQUIPMENT

Hardware and Miscellaneous

- All hardware chrome on brass or stainless steel
- Anchor, anchorline, and chocks
- Rope deck pipe
- Bow and stern chocks and cleats
- Four springline cleats
- Stainless steel deck rail with chains at boarding gates
- Stainless steel flying bridge rails
- Fog bell
- Boat hook
- Zincs on rudders and shafts
- Dual air/electric horn
- Non-skid on exterior decks
- Bow and stern staffs with ensign and pennant
- Life ring
- Life jackets
- Nylon mooring lines
- Portable fire extinguishers
- Trim tabs
- Bottom paint
- Stainless steel propeller shafts
- Bronze struts and rubber strut bearings
- Propellers
- Bronze rudders
- Gel exterior finish

Engine Compartment and Bilge

- 12 volt enclosed lights
- 12 volt bilge blowers
- Twin diesel freshwater-cooled, or twin gas sea water-cooled main engines with marine gear, hour meters, alternators, fuel filters, and sea water strainers
- 6.5KW gas or 8KW diesel generator with sea water strainers, freshwater cooling, remote start, hour meter, water lift muffler and sound enclosure (diesel only)
- Fixed fire extinguisher system for engine compartment with automatic and remote manual control plus audible and visual signals
- Freshwater pressure system with electric water heater and water fill hose for engines and generator
- Dockside water connection with pressure reducing valve
- Automatic bilge pumps, portable bilge pump
- Sea valves on all underwater through hull fittings with electrical bonding throughout
- U.L. approved reinforced fiberglass fuel tank
- Sewage holding tank plumbed for dockside discharge with level indicator light in heads
- 1³/₄" stainless steel propeller shafts

Electrical Systems

- Two heavy duty 12 volt batteries
- 120 volt automatic battery charger, 40 amp
- Battery paralleling system with switch at control console

- One 120 volt, 30 amp, transformer connected, fused shoreline inlet with cord
- One 240 volt, 50 amp, transformer connected, fused shoreline inlet with cord
- 12 and 120 volt lighting fixtures
- 120 volt duplex electrical outlets
- Battery control panel with fusing and isolation switches
- DC distribution panel with magnetic circuit breakers and battery condition meter
- AC switching panel with volt meter, ammeter, and interlock selector breakers
- AC distribution panel with magnetic circuit breakers
- Systems monitor: visual and audible signals for engine functions; engine oil pressure, engine coolant temperature, drive oil temperature, exhaust temperature; fire warning for engine compartment, engine compartment fire system discharge; high bilge water alarm and AC power loss
- Ground fault protection on AC receptacle and lighting circuits
- Navigation lights

Salon

- Wood paneling
- Carpeting with padding
- Vinyl headlining
- Draperies with valance boards upholstered to match
- Bound access hatch to engine compartment
- Tinted safety glass
- Sliding side windows
- Windshield cover
- 120 volt duplex electrical outlets
- 12 and 120 volt light fixtures
- Storage cabinet, port side
- L-shaped lounge with sleeper
- Occasional chair
- Hi-Lo table
- Parsons stools (2)

Galley

- High pressure laminate countertops
- Storage cabinets and drawers
- AC/DC refrigerator with freezer
- 240 volt three-burner range with oven
- Stainless steel sink
- 12 and 120 volt light fixtures
- 120 volt duplex electrical outlets
- Vinyl floor covering

Flying Bridge

- Molded fiberglass
- Bench seat with vinyl covered polyfoam cushions
- Storage under seat and console
- Stainless steel rails and stanchions
- Tinted acrylic windshield
- Control station with all necessary switches and dimmable lighted instruments
- Compass with dimmable light
- Dual lever clutch and throttle controls
- Hydraulic steering
- Helmsman and companion bench seat

- 12 volt weatherproof receptacle
- Electronics mounting panel with acrylic cover

Aft Deck

- Molded fiberglass with non-skid surface
- Dodger boards
- Stainless steel flying bridge ladder with teak steps
- Door/hatch to salon
- Walkways to forward deck

Bow Stateroom

- Carpeting
- Padded vinyl covering on hullside and vinyl headlining
- Vee berths with polyfoam mattresses, spreads, pillows, pillow shams, mattress pads, and sheets^(E)
- Storage and drawers under berths
- Rope storage locker
- Hanging locker
- Ventilated frosted portlights and screened overhead hatch
- 12 and 120 volt light fixtures
- 120 volt duplex electrical outlets
- Full length mirror

Heads (Two)

- Vinyl flooring
- Vinyl headlining
- High pressure laminate countertops
- Stall shower with automatic sump pumps
- Linen locker (bow head)
- Storage cabinet with mirror
- Storage cabinet under counter
- Towel bars
- Retractable clothesline
- Electric toilet
- 120 volt exhaust blower
- 12 and 120 volt light fixtures
- 120 volt duplex electrical outlets
- Ventilating portlight with draperies (window in aft head)
- Bulkheads covered with waterproof vinyl fabric or high pressure laminate

Master Stateroom

- Wood paneling
- Carpeting
- Queen berth with polyfoam mattress, spread, pillow, pillow shams, mattress pad, and sheets^(E)
- Nightstand with drawers
- Hanging locker with light
- Sliding side windows
- 12 and 120 volt light fixtures
- 120 volt duplex electrical outlets
- Full length mirror
- Draperies with valance boards upholstered to match
- Dressers port and starboard with 9 drawers
- Large portlight in transom

OPTIONAL EQUIPMENT

Base Options

• Controls, Salon ^(C)	\$6,265
• Air Conditioning, Reverse-Cycle Heat ^(C)	8,940
• Electric Heater ^(C)	1,555
• Ice Maker in Salon Cabinet ^(L)	990
• AM/FM Stereo with Tape Deck	1,030
• Swim Platform ^(D)	4,415
• Radar Arch	5,765
• Hardtop and Arch	8,940
• Closed Cooling System, Gasoline Engines	1,450
• Water Delivery Kit ^(G)	905
• Cradle, Heavy Duty	2,845
• New Bern, N.C. Delivery ^(H)	7,065
• Wet Bar with Ice Chest	1,225

Mechanical and Miscellaneous Equipment

• Pulpit, with Stainless Steel Chute and Roller	5,150
• Windlass: Model AA	2,345
Model AACW	4,105
• Anchor, with Chocks, Extra	240
• Dunnage Box, Fiberglass	1,325
• Fuel Filter/Water Separator (Generator)	455
• Wash Down, Freshwater, Midship	470
• Wash Down, Sea Water, One Outlet ..	1,165
• Spare Propellers, Gas	1,185
• Spare Propellers, CAT 3208TA	1,710
• Spare Prop Shaft (1 piece)	1,185
• Sea Ladder, Marquipt ^(L)	975
• Oil Changing System (Diesel)	720

Electronics, Gauges and Instruments^(F)

• Depthfinders: Datamarine, 3000 Digital	1,810
• VHF/FM Radiotelephones: Raytheon 77	1,675
• SSB Radiotelephones: Raytheon Model 150	6,465
• Hailer/Intercom, Raytheon 410	1,385
• Loran: Raytheon, Model 570	2,130
• Radar: Raytheon R-21	5,595
• Autopilot: Robertson AP200DL	6,845
Hand-Held Remote Station (each) ..	970
• Speed/Distance: Datamarine 3200 Digital	1,870
• Rudder Angle Indicator, Yachtmaster ..	745
• Glendinning Synchronizer, Engine: Single Station (Diesel)	2,115
• Compass Compensation, One ^(L)	255

Canvas

• Bimini Top, Folding with Boot	1,650
• Flying Bridge Enclosure, 4 Sides	2,575
• Flying Bridge Enclosure, 3 Sides	2,030
• Flying Bridge Cover	755
• Flying Bridge Instrument Cover	160
• Flying Bridge Helmseat Covers	135
• Searchlight Cover, Canvas Front	90
• Depthfinder Cover	70

Electrical and Appliances

• Telephone/CATV Inlet ^(I)	585
• Telephone Outlet, Add'l. (each)	245
• TV Antenna, One Outlet, Omni-Directional	955
• TV Outlets, Add'l. (each)	365
• Receptacle, Weatherproof, 12V	270
• Searchlight, Hand-Held, 6"	240
• Searchlight, One Mile Remote, 10" ..	2,520
• Docking Lights, Transom (pair)	1,400
• Docking Lights, Bow (pair)	1,400
• Garbage Disposal ^(C)	520
• Microwave Oven	685

Decor and Furnishings

• Carpeting, Non-Standard Areas: Head (each)	120
Galley	270
• Headboards, Upholstered (each) Queen Berth, Non-Quilted Fabric ..	365
Queen Berth, Quilted Fabric	395
• Sheets, Add'l Set, Single Berth ^(E)	70
• Sheets, Add'l Set, Queen Berth ^(E)	80
• Mattress Pads, Add'l., (each)	70
• Pillow, Add'l., Dacron Filled	35

Paint^(C)

• Boot Top, Optional Color	195
• Feature Stripe, Optional Color	340
• Feature Stripe, Double Colors	700
• Transom Lettering: Name and Port ^(K) ..	320

NOTES TO SPECIFICATIONS AND EQUIPMENT

(A) Right is reserved to make changes at any time, without notice, in prices, materials, specifications and equipment. Orders are accepted subject to prices prevailing at time of shipment. In order to show equipment size and location, line drawing may include some optional items.

(B) Weight shown is estimate of model's maximum weight displacement with largest engines available, average optional equipment aboard at time of delivery and fuel and freshwater tanks filled. Capacities of tanks are estimated to be total capacity of all tanks normally furnished in this model. Usable capacities will vary depending upon conditions.

(C) These prices apply only if order is placed prior to boat going into production.

(D) Includes swing-down ladder to water, aft deck gate and transom ladder.

(E) One set of sheets includes: one bottom sheet, one top sheet and one pillowcase(s). Colors on request.

(F) Prices are for surface-mount only. Custom installation extra.

(G) Includes 2 qts. A.T. fluid, 1 case oil, oil spout, assortment of screws, bulbs and fuses, deck mop and brush, bucket, hose, nozzle, 3 fenders, 1 set filters, belts, impellers and solenoids for main engines, 1 set of filters and impellers for generator.

(H) Fuel additional.

(I) Includes exterior inlet for telephone and cable TV with one telephone outlet and one TV outlet.

(J) In lieu of salon forward port storage cabinet.

(K) New Bern delivery only.

(L) Complete with storage brackets.

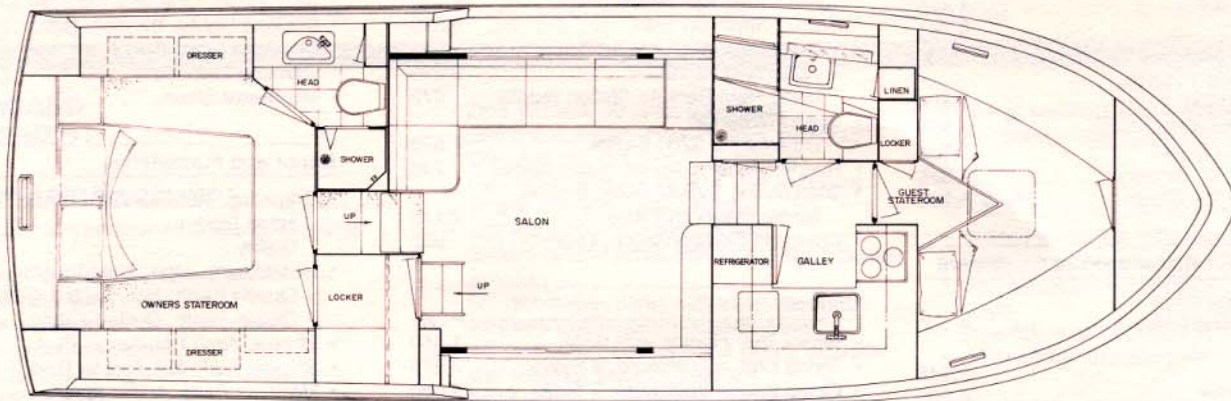

Hatteras Limited Warranty

1. THERE ARE NO EXPRESS WARRANTIES ON PRODUCTS MANUFACTURED BY HATTERAS YACHTS, EXCEPT THAT The Company will, through its selling Dealer, replace or repair, at the Company's option, any part (except as hereinafter provided) which is proven to its satisfaction to have been defective at the time of delivery to the first owner, and which defect is discovered within six months from the date of delivery to the first owner, if the part is returned, transportation prepaid, within thirty days after the defect is discovered, to the Dealer or to such other point of manufacture as the Company may designate.
2. This warranty shall not apply to:
 - (a) The cost of removal or reinstallation of part, or disassembly or reassembly of the unit of which it is a component.
 - (b) Varnishes, gelcoats, paints, fabrics, chromium plated and stainless steel finishes because of the varying effect resulting from different climatic and use conditions.
 - (c) Products not of the Company's manufacture. Any warranty provided by the manufacturer will be passed on to the owner if possible.
 - (d) The installation of any equipment by a Dealer or other installer.
 - (e) Racing boats or engines.
 - (f) Speeds, fuel consumption and other performance characteristics because they are estimated and not guaranteed.
 - (g) Conditions resulting from misuse, abuse, negligence, alteration or lack of performance of normal maintenance.
 - (h) Others than the first owner.
 - (i) Boats that are used in commercial or military activities.
3. THE DURATION OF ANY IMPLIED WARRANTY OR MERCHANTABILITY OR FITNESS FOR A PARTICULAR PURPOSE OR OTHERWISE SHALL BE LIMITED TO AND COINCIDENT WITH THE DURATION OF THIS EXPRESS WARRANTY. The replacement or repair of defective parts as stated in this warranty shall be the sole remedy of the purchaser and the sole liability of the dealer and the company under this warranty and any implied warranties. THE COMPANY OR ITS DEALER SHALL NOT BE LIABLE UNDER ANY CIRCUMSTANCES FOR LOSS OF TIME, INCONVENIENCE, LOSS OF USE, OR FOR ANY OTHER INCIDENTAL, CONSEQUENTIAL OR INDIRECT DAMAGES.
 - (a) Some states do not allow limitations on how long an implied warranty lasts or on the exclusion of incidental or consequential damages, so the above limitation on the duration of implied warranties and the above exclusion of incidental and consequential damages may not apply to you.

4. THIS WARRANTY IS EXPRESSLY IN LIEU OF ANY NON-CONTRACTUAL LIABILITIES, INCLUDING PRODUCT LIABILITIES BASED UPON NEGLIGENCE OR STRICT LIABILITY.
5. THE DEALER IS NOT THE AGENT OF HATTERAS YACHTS. The Company does not authorize the Dealer, or any other person, to assume for the Company any liability in connection herewith or any liability or expense incurred in the repairing of its products other than those expressly authorized herein. THE DEALER MAY NOT EXTEND, OR IN ANY WAY CHANGE OR AMEND, THIS EXPRESS WARRANTY.
6. The Company reserves the right to improve its products through changes in design or material without being obligated to incorporate such changes in products of prior manufacture.
7. You may secure performance of warranty obligations hereunder by:
 - (a) Oral or written communication with the Hatteras Dealer from which you purchased the boat, making an appointment to have the Dealer examine your Hatteras boat.
 - (b) Delivering your Hatteras boat to the selling Hatteras Dealer for his examination.
 - (c) In certain cases the Dealer is authorized to complete Hatteras Limited Warranty obligations unilaterally, and in others he must receive authorization from the Hatteras Service Department. The Dealer is obliged to follow whichever course is appropriate.
 - (d) Upon completion of Hatteras Limited Warranty obligations, the Dealer will notify you of the availability of your Hatteras boat for your pickup.
 - (e) Major mechanical components, such as engines, generator sets, electronics, appliances, and air conditioning, for example, are warranted by the manufacturer of the component. They have authorized service dealers in most major boating markets. Your Hatteras Dealer will identify such service dealers upon request.
8. Any other communications necessary in connection with this warranty should be sent to the following address:

HATTERAS YACHTS
Attention: Director of Service
2100 Kivett Drive
P. O. Box 2690
High Point, North Carolina 27261
9. THIS WARRANTY GIVES YOU SPECIFIC LEGAL RIGHTS, AND YOU MAY ALSO HAVE OTHER RIGHTS WHICH VARY FROM STATE TO STATE.

Hatteras

Hatteras Yachts

High Point, North Carolina 27261 U.S.A.

Hatteras Yachts is a registered trademark of Genmar Industries, Inc.

©1987 Hatteras Yachts, Division Genmar Industries, Inc.

BG40DC20887