

Hatteras[®]

40 MOTOR YACHT

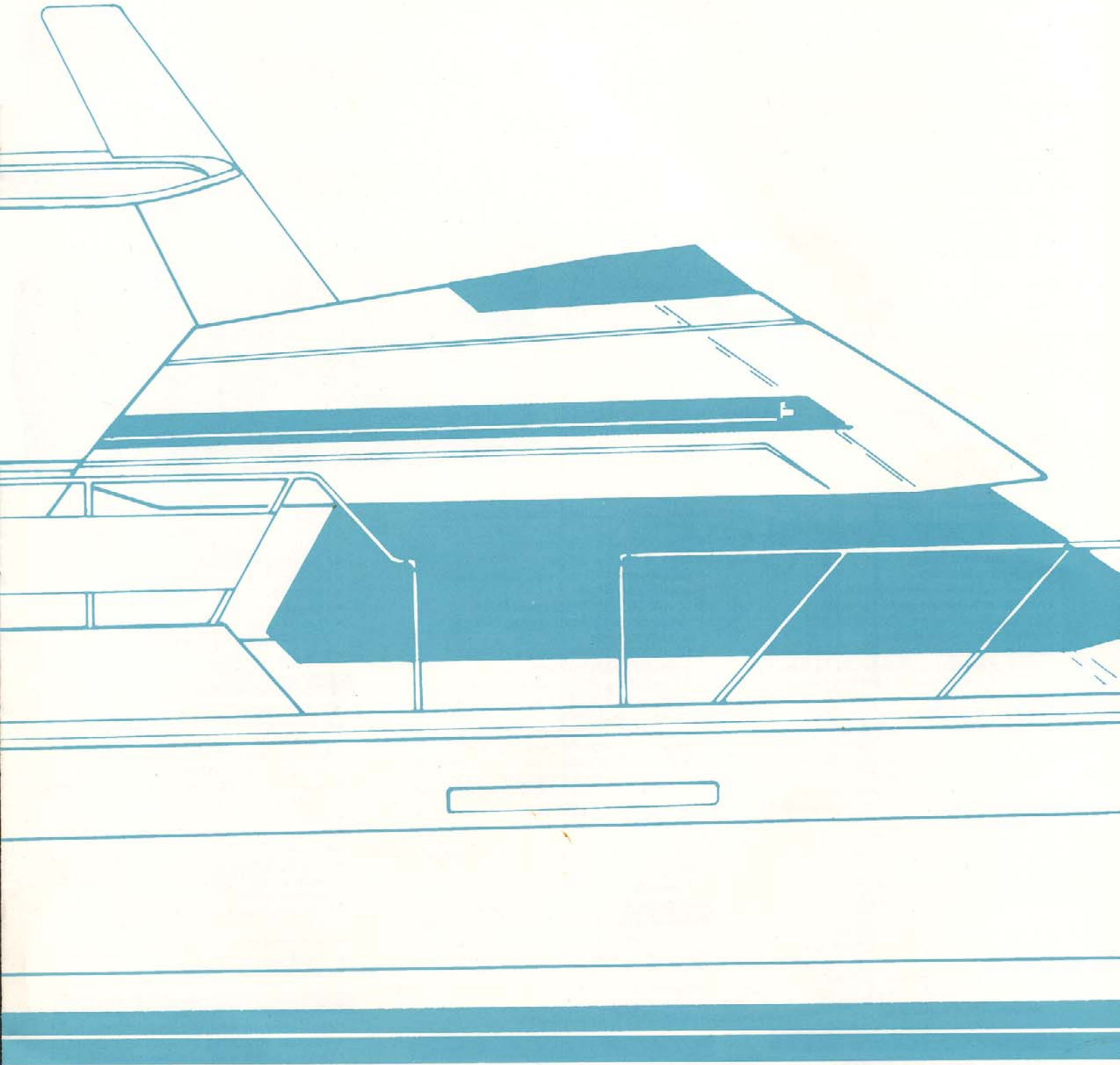

EFFECTIVE AUGUST 1, 1994

STANDARD EQUIPMENT^(A)

Exterior Finish

- Isophthalic gelcoat, interior layer, grey
- Isophthalic gelcoat, exterior layer, white
- Blisterguard[®] gelcoat, exterior layer below waterline, white
- Topsides and superstructure, Dupont Imron polyurethane coating
- Epoxy/copper based anti-fouling bottom paint
- Feature stripes and boot stripe, Dupont Imron polyurethane coating
- Decks, non-skid surface, Dupont Imron polyurethane paint with polymeric beads

Hardware and Miscellaneous

- All hardware chrome on brass or stainless steel
- Fiberglass pulpit
- Anchor, anchor line and deck hawse pipe
- Transom reboarding steps
- Bow and stern chocks and cleats
- Four springline cleats
- Stainless steel deck rail with chains at boarding gates
- Fog bell
- Boat hook
- Zincs on rudders and shafts
- Dual air/electric horn
- Bow and stern staffs with ensign and pennant
- Life ring
- Life jackets (6)
- Nylon mooring lines (4)
- Portable fire extinguishers
- Trim tabs with zincs
- Bronze struts and elastomeric strut bearings
- Bronze rudders
- Propellers
- 1¼" stainless steel propeller shafts

Engine Compartment and Bilge

- 12 volt enclosed lights
- 12 volt bilge blowers
- Twin diesel freshwater-cooled main engines with marine gears, exhaust silencers, hour meters, alternators, fuel filters and seawater strainers
- Fixed fire extinguishing system for engine compartment with automatic and remote manual controls, plus audible and visual discharge signals
- 8Kw diesel generator^(D) with seawater strainers, freshwater cooling, remote start, hour meter and water lift muffler
- Pressurized freshwater system with 11-gallon electric water heater
- Water fill hose for engines and generator
- Dockside water connection with pressure-reducing valve
- Five automatic, electric bilge pumps and one portable, manual bilge pump
- Ball-valves on all underwater through hull fittings with electrical bonding throughout
- U.L. approved fiberglass reinforced fuel tanks
- Sewage holding tank plumbed for dockside discharge with level indicator light in heads
- Fuel filter/water separator, generator
- Fuel filters/water separators, engines
- Fuel tank selector manifold

Electrical Systems

- Two heavy duty 12 volt batteries
- 120 volt automatic battery charger, 60 Hz
- Battery paralleling system with switch at control console
- Transformer connected shoreline inlets

- One 120 volt, 30 amp, fused electrical inlet with cord
- 12 and 120 volt light fixtures
- 120 volt duplex outlets
- Battery control panel with fusing and isolation switches
- 12 volt DC distribution panel with magnetic circuit breakers and battery condition meter
- 120 volt AC distribution panel with magnetic circuit breakers
- AC switching panel with volt meter, ammeter and interlock selector breakers
- 6-Point systems monitor with visual and audible signals for: (a) engines — oil pressure, coolant temperature, drive oil temperature, exhaust temperature, (b) high bilge water, (c) fire warning in engine compartment, (d) engine compartment fire extinguishing system discharge, (e) AC power loss
- CATV inlet
- Ground fault protection on AC receptacles and lighting circuits
- Navigation lights

Aft Deck

- Molded fiberglass with non-skid surface
- Dodger boards
- Stainless steel flying bridge ladder with teak steps
- Door to salon
- Walkways to forward deck

Flying Bridge

- Molded fiberglass
- Three bench seats with vinyl-covered polyfoam cushions
- Storage under seat and console
- Stainless steel rails and stanchions

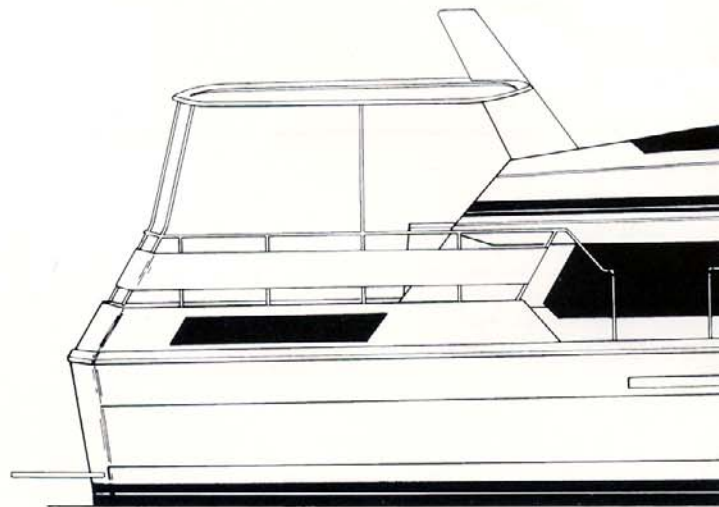

40 MOTOR YACHT

Length Overall ^(B)	40'10"	12.44 m
Beam	13'7"	4.14 m
Draft ^(C)	4'9"	1.45 m
Freeboard Forward ^(C)	5'6"	1.68 m
Freeboard Aft ^(C)	4'1"	1.24 m
Headroom Most Areas	6'5"	1.96 m
Freshwater Capacity ^(C)	110 Gals	416 ltr
Fuel Capacity ^(C)	359 Gals	1,359 ltr
Weight Displacement ^(C)	38,000 Lbs	17,237 kg

- Tinted acrylic windshield
- Control station with all necessary switches and dimmable lighted instruments
- Compass with dimmable light
- Dual lever clutch and throttle controls
- Hydraulic steering
- Helmsman seat
- Two recessed electronics boxes in console with plexiglass weathershields
- Fuel level gauge

Salon

- Wood paneling
- Carpeting
- Vinyl headlining
- Mini blinds with lambrequins and vinyl-covered valance boards
- Bound access hatch to engine compartment
- Tinted safety glass
- Sliding side windows
- Windshields
- 13" color TV
- Cassette tape player with AM/FM stereo receiver
- Stereo speakers
- L-shaped lounge with storage
- Hi-lo table
- Occasional chair
- 12 and 120 volt light fixtures
- 120 volt duplex outlets

Galley

- High pressure laminate countertops
- Vinyl floorcovering
- Storage cabinets and drawers
- AC/DC refrigerator with freezer
- 120 volt, two-burner cooktop
- Microwave/convection oven
- Water level gauge
- Stainless steel sink

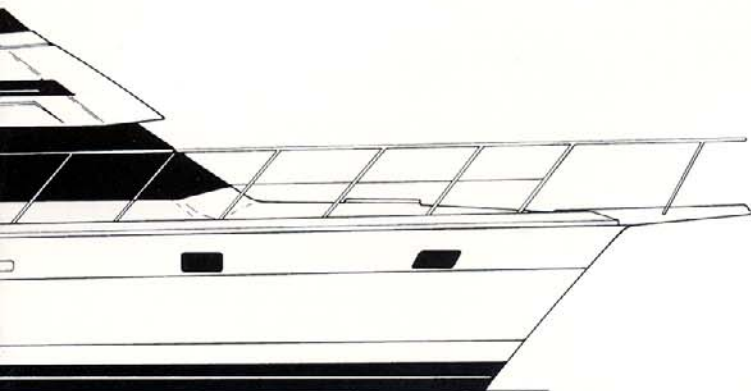

T^(A) Specifications

Overhead Obstruction Clearance

Required to Top of Flying Bridge

Windshield Handrail^(C) 12'2" 3.71 m

To Top of Optional Radar Arch^(C) 15'9" 4.80 m

- Twin D.D. 4-71TI Diesel Engines 314 SHP
- Twin CAT 3116TA Diesel Engines 340 SHP
- Twin CAT 3208TA Diesel Engines 364 SHP
- Twin D.D. 6V-53TI Diesel Engines 388 SHP
- Twin Volvo TAMD72 Diesel Engines 417 SHP

- 12 and 120 volt light fixtures
- 120 volt duplex outlets

Master Stateroom

- Wood paneling
- Carpeting
- Queen berth
- Polyfoam mattress, spread, pillows, pillow shams, mattress pad and sheets^(E)
- Hanging locker with doors and automatic light
- Nightstand with drawers
- Reading lamps
- Dressers, port and starboard with 8 drawers
- Mini blinds with lambrequins and vinyl-covered valance boards
- Large portlight in transom
- Sliding side windows
- Stereo speakers with volume control
- 12 and 120 volt light fixtures
- 120 volt duplex outlet
- Full-length mirror

Bow Stateroom

- Carpeting
- Padded vinyl covering on hullside
- Vinyl headlining
- Vinyl wallcovering
- Upper and lower berths with storage underneath
- Polyfoam mattresses, spreads, pillows, pillow shams, mattress pads and sheets^(E)
- Lounge seat
- Dresser with drawers
- Rope storage locker
- Hanging locker
- Frosted ventilating portlights
- Screened overhead hatch
- 12 and 120 volt light fixtures
- 120 volt duplex outlets
- Full-length mirror

Heads (Two)

- Vinyl floorcovering
- Vinyl headlining
- High pressure laminate or vinyl-covered bulkheads
- One piece molded lavatory and countertop
- Storage cabinet with mirror
- Storage cabinet under counter
- Stall shower with door and automatic sump pump
- Linen locker (bow head)
- Towel bar
- Vacu-flush toilet
- Exhaust blower
- 12 and 120 volt light fixtures
- 120 volt duplex outlet
- Ventilating portlight in bow head
- Window in aft head
- Draperies

OPTIONAL EQUIPMENT^(A)

Base Options

- Aft Deck Enclosure with Full Dodger^{(F)(G)} \$9,350
- Controls, Salon^{(F)(H)} 7,580
- Wet Bar with Ice Chest, Aft Deck^(F) 1,995
- Dry Bar with Bottle and Glass Storage^{(F)(H)} 1,290
- Dinette with Storage, Salon^(I) 2,495
- New Bern, NC Delivery^(K) 9,355
- Cradle, Heavy Duty 3,715
- Water Delivery Kit^(L) 1,455

Mechanical and Miscellaneous Equipment

- Windlass:
 - Model AA 2,995
 - Model AACW^(M) 5,685
- Anchor Chute with Roller 1,335
- Anchor, with Chocks, Extra 310

- Radar Arch 7,515
- Hardtop and Arch 13,155
- Swim Platform with Reboarding Ladders and Gate 5,750
- Sea Ladder With Storage Brackets 1,275
- Oil Changing System 1,180
- Wash Down, Freshwater, Midship 590
- Wash Down, Seawater, One Outlet 1,655
- Spare Propellers, D.D. 4-71TI^(N) P.O.R.
- Spare Prop Shaft, 1 Piece, D.D. 4-71TI^(N) 1,345
- Spare Propellers, CAT 3116TA^(N) P.O.R.
- Spare Prop Shaft, 1 Piece, CAT 3116TA^(N) 1,345
- Spare Propellers, CAT 3208TA^(N) P.O.R.
- Spare Prop Shaft, 1 Piece, CAT 3208TA^(N) 1,535
- Spare Propellers, D.D. 6V-53TI^(N) P.O.R.
- Spare Prop Shaft, 1 Piece, D.D. 6V-53TI^(N) 2,560
- Spare Propellers, Volvo TAMD72^(N) .. P.O.R.
- Spare Prop Shaft, 1 Piece, Volvo TAMD72^(N) P.O.R.
- Prop Puller 1,300
- Rudder Angle Indicator, VDO 965
- Engine Synchronizer, Single Station, Diesel 2,755
- Generator Sound Enclosure 1,015
- Compass Compensation, One^(O) 395
- Compass Compensation, Two^(O) 460

Canvas

- Bimini Top, Folding With Boot 2,150
- Flying Bridge Enclosure, 4 Sides 3,200
- Flying Bridge Enclosure, 3 Sides 2,515
- Flying Bridge Cover 1,275
- Flying Bridge Instrument Cover 245
- Flying Bridge Helmseat Cover (each) 190
- Windshield Cover 255

Electrical and Appliances^(P)

- 13" Color TV, Master Stateroom 1,445
- TV, Multi-standard P.O.R.
- VCR, Salon^(P) P.O.R.
- VCR, Multi-standard^(P) P.O.R.
- CD Player, Salon^(P) P.O.R.
- Garbage Disposal 660
- Ice Maker in Salon Cabinet^(P) 1,245
- Compact Washer/Dryer 2,655
- Electric Heater 2,030
- Air Conditioning with Reverse-Cycle Heat^(Q) 11,130
- Telephone Inlet/Outlet with Cordset 465
- Telephone Outlet, Add'l., (each) 335
- TV Outlet, Add'l., (each) 450
- Receptacle, Weatherproof, 120V 370
- European Conversion Package, 220v/50Hz P.O.R.
- Searchlight, Hand-held, 6" 340
- Searchlight, Remote-Controlled 3,070
- Docking Lights, Transom (pair) 1,765
- Docking Lights, Bow (pair) 1,840
- Docking Light Switches, Add'l., (each) .. 360

Decor and Furnishing

- Carpeting, Non-Standard Areas —
 - Head (each) 225
 - Galley 360
- Upholstered Headboard, Non-quilted, Queen 385
- Sheets, Add'l. Set, Single Berth^(E) 95
- Sheets, Add'l. Set, Queen Berth^(E) 120
- Mattress Pad, Add'l., (each) 100
- Pillow, Add'l., Dacron Filled 35

Paint^(P)

- Boot Top, Optional Color 250
- Bridge Stripe, Optional Color 440
- Bridge Stripe, Double Colors 910

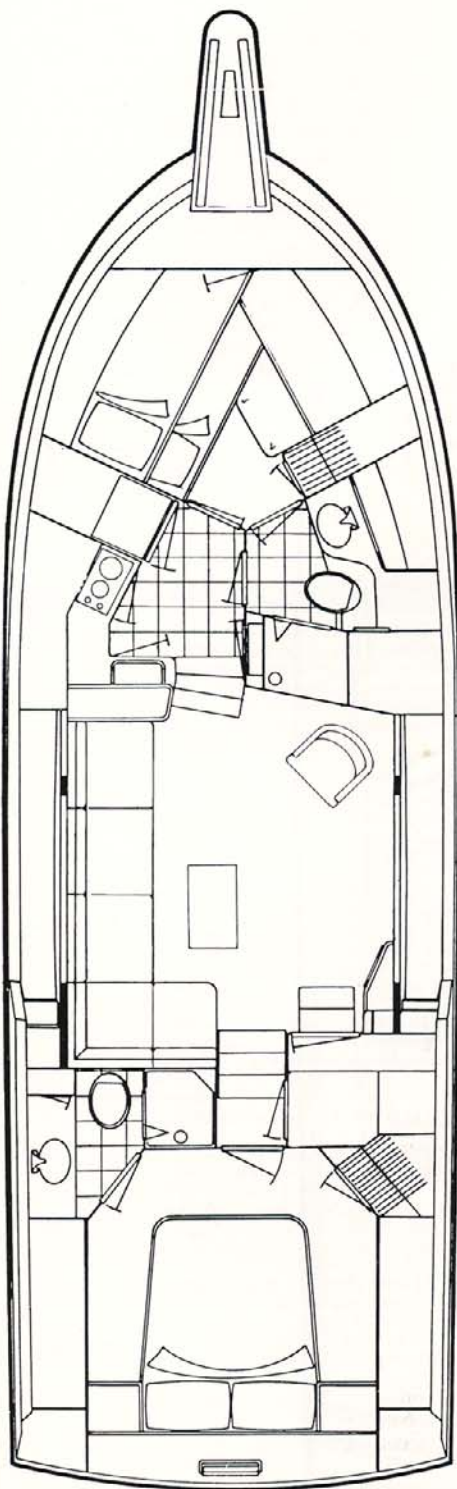

STANDARD
ARRANGEMENT

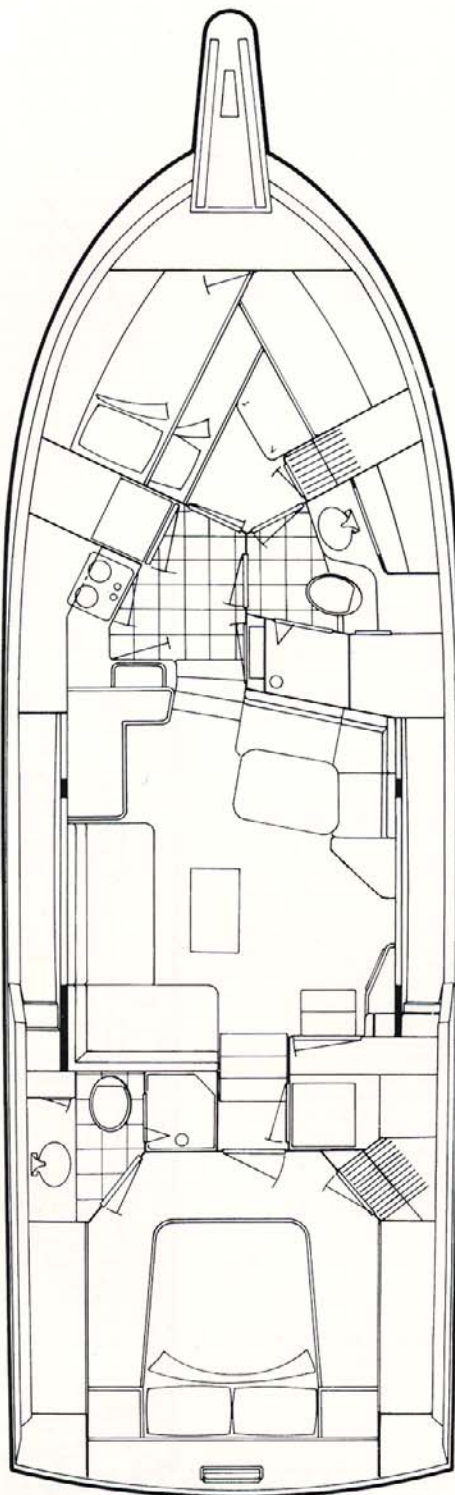

OPTIONAL
ARRANGEMENT

40MY

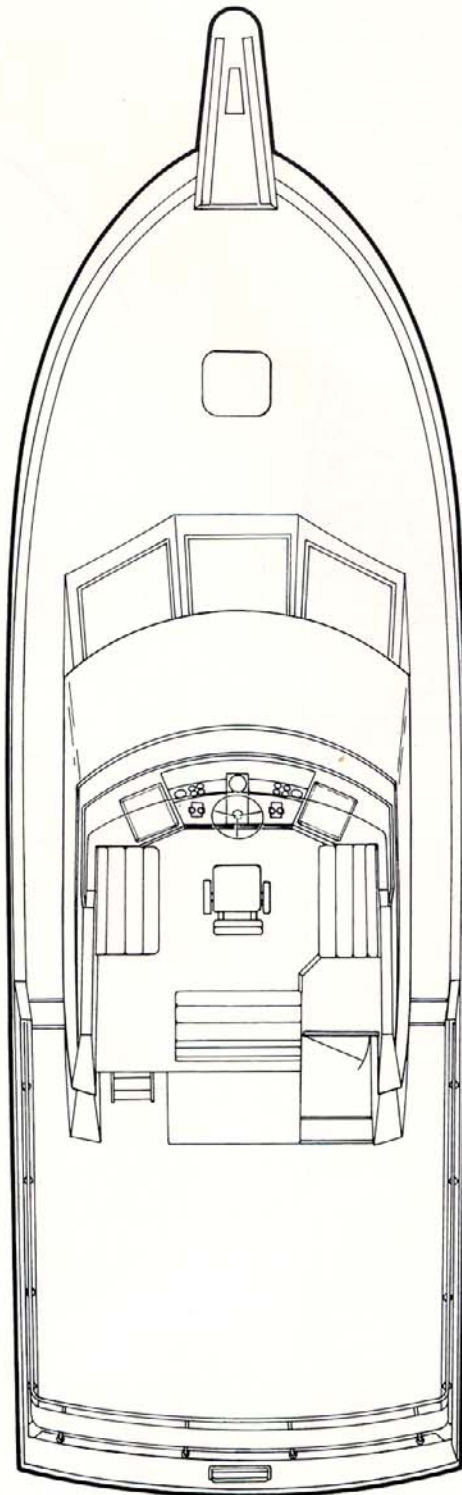

BRIDGE

40MY

NOTES TO SPECIFICATIONS AND EQUIPMENT

- (A) Right is reserved to make changes at any time, without notice, in prices, material, specifications and equipment. Orders are accepted subject to prices prevailing at time of shipment. Orders requesting any material and/or equipment which differs from that selected by Hatteras as standard or optional for this model will be considered a custom change and will require additional charges. Prices shown for many options may apply only if ordered prior to start of production. Once production begins, orders for such options may require additional charges due to non-standard installation requirements and/or lead times. In order to show equipment size and location, line drawing may include some optional items. Specifications, standard equipment, and optional equipment effective with boats sold at August 1, 1994 through July 31, 1995 Hatteras Base Prices. Prices are quoted in U.S. dollars.
- (B) Length overall does not include the swim platform or bow pulpit.
- (C) Weight, draft, freeboard and height are based on an estimate of model's displacement with largest engines available. Weight is estimated with fuel, holding and freshwater tanks half filled. Draft and freeboard are estimated with all tanks filled. Heights are estimated with all tanks empty. Actual figures will vary depending on production tolerances, equipment, supplies and stores on board, as well as operational and sea conditions. Capacities of tanks are estimated to be total capacity of all tanks normally furnished in this model. Usable capacities will vary depending upon conditions.
- (D) Generator is not intended to supply power for all standard and optional accessories. Load must be limited to generator output rating.
- (E) One set of sheets includes: one bottom sheet, one top sheet, pillowcase(s).
- (F) Option must be ordered prior to start of production. Price shown reflects cost of scheduled installation requirements. A late request for this option will require an additional charge.
- (G) If Flying Bridge Enclosure is desired, should be 4-sided.
- (H) Optional dry bar and optional ice maker not available with installation of control station in salon's port forward corner. Price shown includes credit for omitted cabinetry.
- (I) Visibility is limited from salon controls and varies depending on operating circumstances and conditions. Use caution and refer to Owner's Manual instructions. This installation allows the use of only Solex tinted, light-green glass in all salon windows, as well as the windshield. Darker tints, such as bronze and grey, are not available.
- (J) In lieu of standard hi-lo table and occasional chair.
- (K) Fuel additional.
- (L) Includes 2 qts A.T. fluid, 1 case oil, assortment of screws, bulbs and fuses, deck mop and brush, bucket, hose, nozzle, 3 fenders, 1 set filters, belts, impellers and solenoids for main engines, 1 set of filters and impellers for generator.
- (M) This model is for use with chain and includes 300 ft. of 1/4" Acculoy chain.
- (N) Storage location and installation not included.
- (O) Available only with New Bern delivery.
- (P) Depending upon component(s) selected, cabinet may require modification; however, modification may not accommodate all components offered.
- (Q) Option includes 240 volt, 50 amp, fused electrical inlet with cord.

Hatteras Limited Warranty

1. THERE ARE NO EXPRESS WARRANTIES ON PRODUCTS MANUFACTURED BY HATTERAS YACHTS, EXCEPT THAT The Company will, through its selling Dealer, replace or repair, at the Company's option, any part (except as hereinafter provided) which is proven to its satisfaction to have been defective at the time of delivery to the first owner, and which defect is discovered within twelve months from the date of delivery to the first owner, if the part is returned, transportation prepaid, within thirty days after the defect is discovered, to the Dealer or to such other point of manufacture as the Company may designate.

In addition, the Company will, through its selling dealer, repair any hull which is proven to its satisfaction to have been defective at the time of delivery to its first owner and which defect is discovered and reported within (5) years from the date of delivery to the first owner.

2. This warranty shall not apply to:

- The cost of removal or reinstallation of part, or disassembly or reassembly of the unit of which it is a component.
- Varnishes, gelcoats, paints, fabrics, chromium plated and stainless steel finishes, because of the varying effect resulting from different climatic and use conditions.
- Products not of the Company's manufacture. Any warranty provided by the manufacturer will be passed on to the owner if possible.
- The installation of any equipment by a Dealer or other installer.
- Racing boats or engines.
- Speeds, fuel consumption and other performance characteristics because they are estimated and not guaranteed.
- Conditions resulting from misuse, abuse, negligence, alteration or lack of performance of normal maintenance.
- Others than the first owner.
- Boats that are used in commercial, charter, or military activities.

3. THE WARRANTY PROVISIONS SET FORTH ABOVE ARE EXCLUSIVE AND ARE IN LIEU OF, AND COMPANY DISCLAIMS, ANY AND ALL OTHER WARRANTIES, EXPRESS, IMPLIED OR STATUTORY, WHATSOEVER INCLUDING, WITHOUT LIMITATION, ANY IMPLIED WARRANTIES UNDER THE UNIFORM COMMERCIAL CODE, ANY IMPLIED WARRANTY OF MERCHANTABILITY AND ANY IMPLIED WARRANTY OF FITNESS FOR A PARTICULAR PURPOSE. THE REPLACEMENT OR REPAIR OF DEFECTIVE PARTS AS STATED ABOVE IN THIS WARRANTY SHALL BE THE SOLE AND EXCLUSIVE REMEDY OF ANY PERSON AND SHALL BE THE SOLE LIABILITY OF THE DEALER AND THE COMPANY UNDER THIS WARRANTY AND ANY IMPLIED WARRANTIES WHICH ARE NOT DISCLAIMED HEREIN. THE COMPANY OR ITS DEALER SHALL NOT BE LIABLE UNDER ANY CIRCUMSTANCES FOR LOSS OF TIME, INCONVENIENCE, LOSS OF USE, OR FOR ANY OTHER INCIDENTAL, SPECIAL, CONSEQUENTIAL OR INDIRECT DAMAGES.

Some states do not allow limitations on implied warranties or in the exclusion of incidental or consequential damages, so the above limitation on the exclusion of implied warranties and exclusion on incidental and consequential damages may not apply.

4. THIS WARRANTY IS EXPRESSLY IN LIEU OF ANY NON-CONTRACTUAL LIABILITIES, INCLUDING PRODUCT LIABILITIES BASED UPON NEGLIGENCE OR STRICT LIABILITY.
5. THE DEALER IS NOT THE AGENT OF HATTERAS YACHTS. The Company does not authorize the Dealer, or any other person, to assume for the Company any liability in connection herewith or any liability or expense incurred in the repairing of its products other than those expressly authorized herein. THE DEALER MAY NOT EXTEND, OR IN ANY WAY CHANGE OR AMEND, THIS EXPRESS WARRANTY.
6. The Company reserves the right to improve its products through changes in design or material without being obligated to incorporate such changes in products of prior manufacture.
7. You may secure performance of warranty obligations hereunder by:
- Oral or written communication with the Hatteras Dealer from which you purchased the boat, making an appointment to have the Dealer examine your Hatteras boat.
 - Delivering your Hatteras boat to the selling Hatteras Dealer for his examination.
 - In certain cases the Dealer is authorized to complete Hatteras Limited Warranty obligations unilaterally, and in others he must receive authorization from the Hatteras Service Department. The Dealer is obliged to follow whichever course is appropriate.
 - Upon completion of Hatteras Limited Warranty obligations, the Dealer will notify you of the availability of your Hatteras boat for your pickup.
 - Major mechanical components, such as engines, generator sets, electronics, appliances, and air conditioning, for example, are warranted by the manufacturer of the component. They have authorized service dealers in most major boating markets. Your Hatteras Dealer will identify such service dealers upon request.
8. Any other communications necessary in connection with this warranty should be sent to the following address:
- HATTERAS YACHTS
Attention: Director of Service
2100 Kivett Drive P.O. Box 2690
High Point, North Carolina 27261
9. THIS WARRANTY GIVES YOU SPECIFIC LEGAL RIGHTS, AND YOU MAY ALSO HAVE OTHER RIGHTS WHICH VARY FROM STATE TO STATE.

Hatteras[®]
The World's Premier Yacht Builder

Hatteras Yachts
2100 Kivett Drive, P.O. Box 2690
High Point, NC 27261 U.S.A.
(910) 889-6621