

Hatteras

55 CONVERTIBLE



Running hard like a bat out of the canyons, the Hatteras 55 Convertible looks so at home in open water, it's difficult to imagine her tethered to the dock. Here is one free-spirited machine, one sportfisherman bred solely for the purpose of taking the best fish, the best trophies. Let there be no doubt: this is one of the brightest examples of how Hatteras has set the standards for the sport.

Here is one truly well-made weapon in the battle for billfish.

Comfortably positioned at the head of the fifty-foot class, the Hatteras 55 balances the agility of smaller boats

with as much working space as the supers. Broad beamed and maneuverable, the 55 has the flexibility to properly seek and land the big fish. Solid and single-minded in design, the 55 provides 158 square feet of cockpit space — plenty of room for fighting the largest blacks and blues.

Overall, the business end of this boat is built for big-game action. Its standard bait and tackle console includes a wet sink, bait work area, tackle compartments, and freezer. And there's enough space left over for optional clutch and throttle controls, or a circulating bait well. Of course, a Hatteras-size extra large transom gate is standard, and a

THE IMPRESSIVE WEAPON FOR TODAY'S OFFSHORE HUNTER.



flush-deck fish box can be added.

In the 55, you can go directly from the cockpit to the engine room below — thanks to a direct access door. The engine room itself is an impressive example of Hatteras's thoughtful approach to design engineering: unlike most other boats in this class, there's plenty of stand-up room here, and good access to all mechanical and electrical components below.

We've equipped the 55 with lots of horsepower in Detroit Diesel 12's, to get you out and back quickly. And, to keep the engine room free from spray and hullside wash,

engine air is drawn from intakes located under the cockpit's coaming.

Above decks, the flybridge is aggressively styled, yet sufficiently spacious for helmsman, crew and guests. The low, aft-raking windshield, the radius forward corners of the bridge and house, and styled side windows produce a clean, low look to the 55. But don't be deceived: the Hatteras traditions for maximized use of space, extra headroom and quality amenities are maintained throughout this convertible.

All in all, from any aspect or angle, the Hatteras 55 Convertible is an impressive sportfishing weapon indeed.





Salon looking forward. More contemporary than ever, with even more storage space in the galley and dinette areas. The conversation between the chef and guests is easy and relaxed.

Liveaboard layouts with weekend conveniences.

In its history of building great sea boats, Hatteras has skillfully built a reputation as well.

The name "Hatteras" is synonymous with boats that have been built first for seaworthiness and performance; second, for top-quality interior layout and design to accommodate the needs and pleasures of their owners.

You'll find that the generous floor plan proportions of the 55 Convertible prove this reputation thoroughly. As you examine its interior, you'll discover the comforts, the conveniences, the enjoyments which are typical of Hatteras.

Two floor plans are available to suit your personal requirements. The standard arrangement has two staterooms, each with private head, and a galley below. The optional plan, which is illustrated here, features three staterooms, along with a deckhouse galley arrangement.

The three stateroom layout includes private heads with stall showers for each. And, of course, all of the staterooms offer loads of locker and storage space. There's even enough room left over below to include a

washer/dryer.

Floor plan efficiency is quite clear to anyone, once aboard. Topside and below, special consideration has been given to traffic patterns. In the deckhouse of the optional arrangement, for example, the galley, dinette, and salon each maintain separate out-of-the-companionway spaces, while working together to form a large common and comfortable living area.

This is the kind of fine-tuned design you can expect from Hatteras, where even the standard layout for the 55 is anything but ordinary.

Salon looking aft (center left). The generous seating and conversation area is enhanced with the view from large patio-like windows.

Galley (lower left) is a modern cook's dream. Side-by-side refrigerator/freezer is home sized. The latest in cook-top range design has four burners. Space-saving oven serves double duty as a microwave and a convection unit.

Dinette (left). It is bright, cheerful and in the right place to allow four to enjoy dining close to the water's edge. Note convenient entertainment center with standard AM/FM stereo radio and cassette deck.



Optional third stateroom. Beautiful proof that guests don't have to be con-tortionists, courtesy of Hatteras.



Master stateroom's head with roomy shower stall.

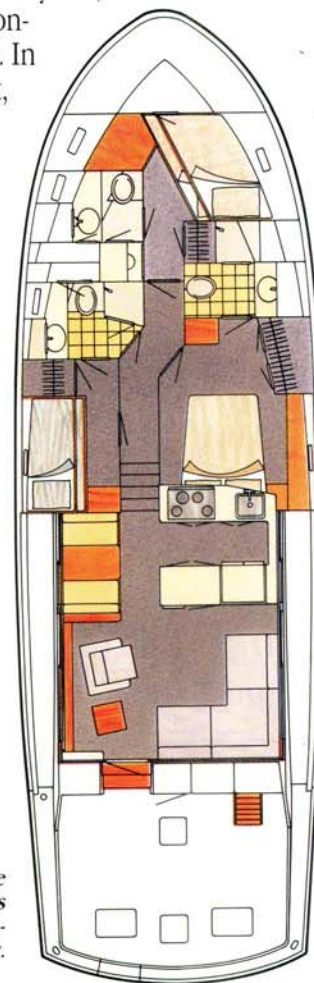

The alternate three stateroom plan has three heads and a top-side galley.

Though styles may change, our standards for comfort and performance never waiver.

Salon of generous proportions seems to say, "Welcome to our place" instead of just "Welcome aboard." Fabrics and furnishings? A wide selection to suit your tastes.

With either interior arrangement, traditional Hatteras comforts have been enhanced with the latest in style and convenience. Light shades of easy-to-clean countertop, wall coverings, burlled dresser tops, and rounded corners bring a fresh, contemporary feel to its interiors. In each head, handsome and durable molded marble countertops are standard. And throughout, the whisper-quiet air conditioning system cools every inch of the 55, including the heads.

The master stateroom is grand: there's space enough to include a walk-around tapered queen-size bed, or twin berths if you prefer.

And in either layout, rich yet practical fabrics selected from a collection we've assembled with life at sea in mind, will allow you to express your own taste and lifestyle.

The standard two-stateroom layout includes private heads with stall showers for each. The galley is well-equipped with a refrigerator/freezer, range, and lots and lots of work space. The adjoining dinette features extra long table and seating, adding comfort to your mealtime.

Topside, the salon offers more than 170 square feet of living area, dimensions you'd usually expect to find in a motor yacht — not a sportfishing boat — and includes a large, convenient bar along the aft bulkhead.

All of these features and more add up to a sportfishing yacht that is uniquely Hatteras, a yacht that is a joy to own.

Your Hatteras dealer can arrange to show the exciting 55 Convertible, to demonstrate its innovative features firsthand. From then on, we believe you'll understand why many experienced boaters and sportfishermen prefer Hatteras convertibles.



Spacious galley with full complement of appliances including 4-burner stove and microwave.

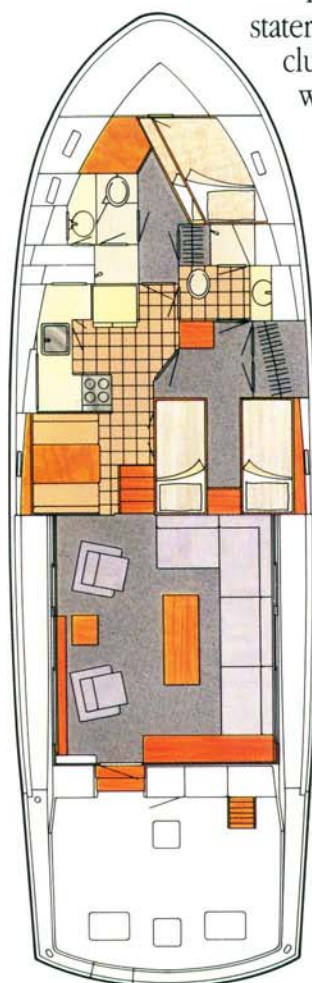

The standard two stateroom plan with lower galley. Plus a salon that's fit for a motor yacht. A **Hatteras** motor yacht.

Bow Stateroom features built-in dresser, plenty of storage and ventilating hatch to foredeck.

Dinette is a built-in fun, food and game area that seats four.



Master Stateroom with fine cabinetry finish features twin berths or optional queen bed, either with excellent walk space.

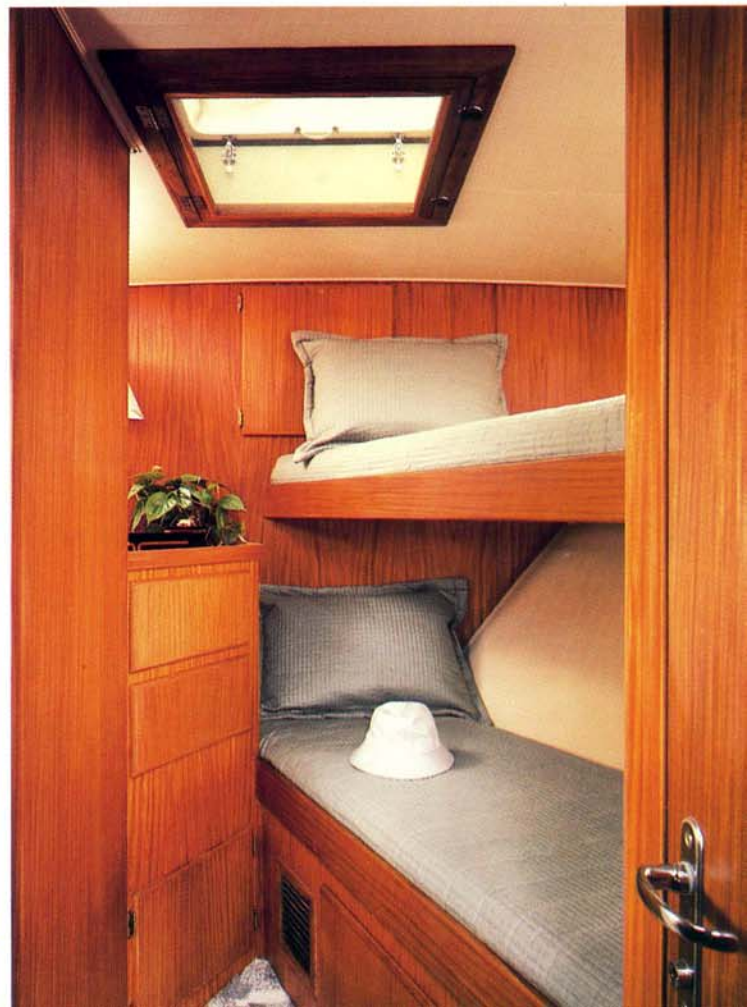

Hatteras Yachts Inc.
2100 Kivett Drive
P.O. Box 2690
High Point, North Carolina 27261 USA
Telephone: (919) 889-6621

Hatteras Yachts reserves the right to make styling, design, equipment and construction changes without notice. Some items shown may be optional.
Hatteras is a registered trademark of Genmar Industries, Inc. © 1987 Hatteras Yachts, Division Genmar Industries, Inc.

55C 15 587
Printed in U.S.A.

