

# *Hatteras*<sup>®</sup>

---

## 60 EXTENDED DECKHOUSE MOTOR YACHT

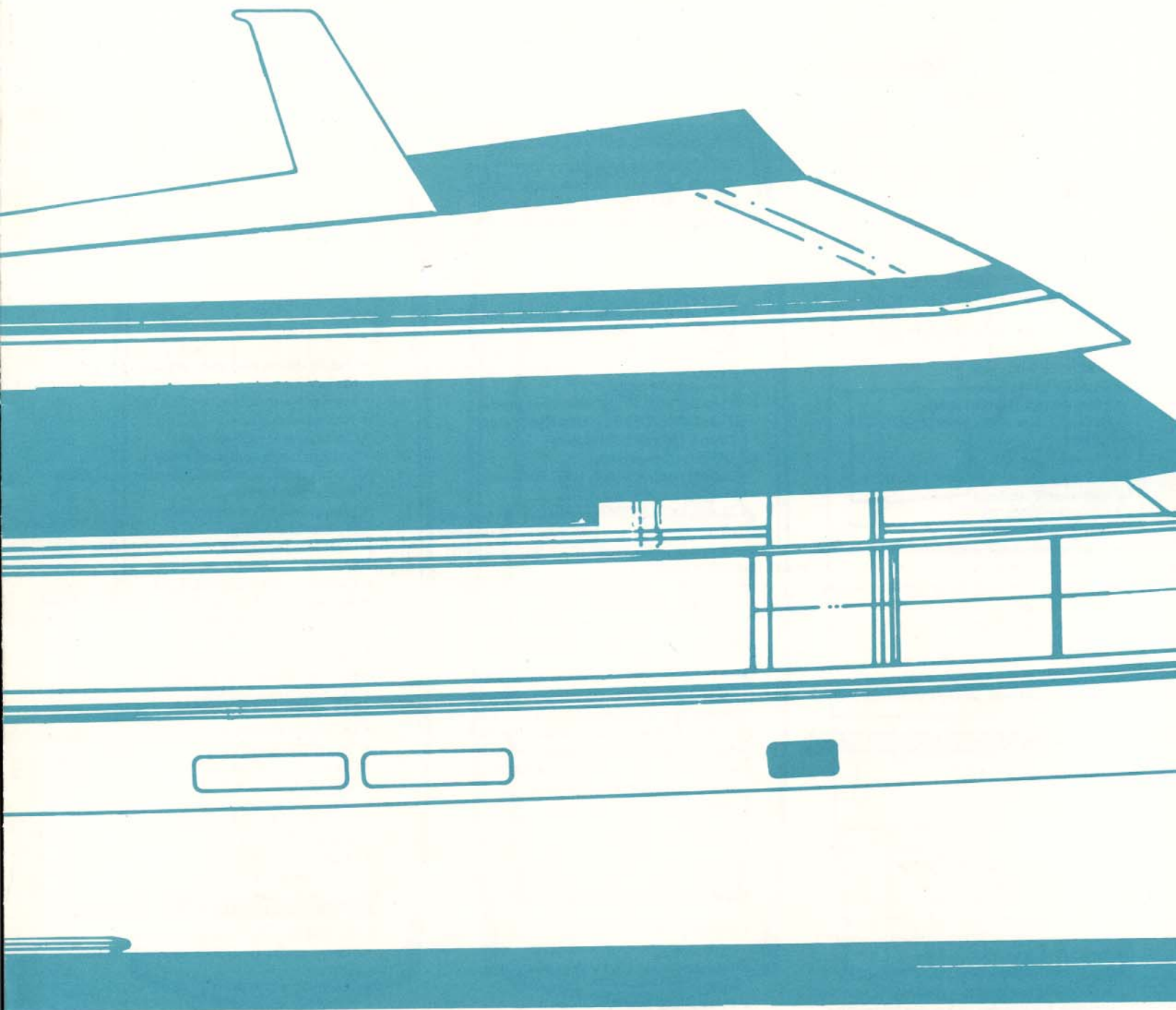

EFFECTIVE AUGUST 1, 1994

## STANDARD EQUIPMENT<sup>(A)</sup>

### Exterior Finish

- Isophthalic gelcoat, interior layer, grey
- Isophthalic gelcoat, exterior layer, white
- Blisterguard® gelcoat, exterior layer below waterline, white
- Topsides and superstructure, Dupont Imron polyurethane coating
- Epoxy/copper based anti-fouling bottom paint
- Feature stripes and boot stripe, Dupont Imron polyurethane coating
- Decks, non-skid surface, Dupont Imron polyurethane paint with polymeric beads

### Hardware and Miscellaneous

- All hardware chrome on brass or stainless steel
- Fiberglass pulpit with stainless steel anchor chute and roller
- Anchor, anchor line and deck hawse pipe
- Swim platform with reboarding ladders and gate
- Six springline cleats with chafing strips
- Bow and stern chocks and cleats
- Deck rail with teak/stainless steel railing and stainless steel stanchions
- Boarding gates port and starboard side decks
- Remote controlled searchlight
- Fog bell
- Boat hook with clips
- Dual air horns
- Zincs on rudders and shafts
- Bow and stern staffs with pennant and ensign
- Mooring lines (6)
- 2½" stainless steel propeller shafts stubbed with muff couplings
- Life jackets (10)
- Life ring
- Portable fire extinguishers
- Trim tabs with zincs
- Bronze rudders and struts with elastomeric strut bearings
- Five-blade propellers
- Prop puller
- Sea stairs with storage brackets
- Foredeck sun lounge pad with cover
- Foredeck seat with storage, cushions and cover

### Engine Compartment And Bilge

- 120 volt fluorescent lights
- 24 volt enclosed lights
- 24 volt bilge blowers
- Twin diesel freshwater-cooled main engines with marine gears, exhaust silencers, engine hour meters, alternators, fuel filters and seawater strainers
- Fire extinguishing systems for engine compartment and generator compartment with automatic and remote manual controls
- Two 120 volt ventilation fans
- 20Kw freshwater-cooled diesel generator<sup>(D)</sup> with sound enclosure, remote start, seawater strainer, hour meter and water lift muffler
- Fuel tank selector manifold
- Freshwater fill hose for engines and generator(s)
- 240 volt compressed air system with air line and regulator

- Dockside water inlets with pressure-regulating valves
- Four automatic, electric bilge pumps and one portable, manual bilge pump
- Ball-valves on all underwater through hull fittings with electrical bonding throughout
- Pressurized freshwater system with 40-gallon electric water heater
- U.L. approved fiberglass fuel tanks
- Sewage holding tanks plumbed for dockside discharge, with level indicator light in heads
- Oil changing system for engines and generator(s)
- Fuel filter/water separator, generator
- Duplex fuel filters/water separators with bypass manifold, engines
- Fuel priming pumps, engines
- Engine synchronizer, dual station
- Overhead grab rails

### Electrical Systems

- Two 24 volt banks of heavy duty 12 volt marine batteries with automatic battery charger, 60 Hz
- Battery paralleling system with switch at control consoles
- Transformer connected shoreline inlets
- Two 120 volt, 50 amp, fused electrical inlets, one each port and starboard
- Two 240 volt, 50 amp, fused electrical inlets, one each port and starboard
- Two 240 volt, 50 amp, retractable shore cords with over current protection, one each port and starboard
- Two 120 volt, 50 amp shoreline cords
- Two 240 volt, 50 amp shoreline cords
- 24 and 120 volt light fixtures
- 120 volt duplex outlets
- Battery control panels with fuses and isolation switches
- 24 volt DC distribution panels with magnetic circuit breakers and battery condition meter
- 24 volt DC electronics panel with magnetic circuit breakers
- 120/240 volt AC distribution panels with magnetic circuit breakers
- AC switching panel with volt meter, ammeter, frequency meter and interlock selector breakers
- 12-Point systems monitor with visual and audible signals for: (a) engines - oil pressure, coolant temperature, drive oil temperature, exhaust temperature, (b) high bilge water, (c) fire warning in engine compartment and living areas, (d) engine compartment fire extinguishing system discharge, (e) AC power loss
- Navigation lights
- Ground fault protection on AC receptacles and lighting circuits
- Air conditioning with reverse-cycle heating
- SSB radio ground screen laminated in cabin top
- Telephone/CATV inlets, one each, port and starboard
- Telephone and CATV shoreline cords, one each
- TV antenna, omni-directional

### Pilothouse

- Wood paneling
- Wood flooring
- Vinyl headlining

- Sliding doors, port and starboard, to side decks
- High pressure laminate chart deck
- Tinted safety glass
- Cruising seat with storage
- Steps to lower companionway
- Three electric windshield wipers, windshield washers and delay
- Windshield cover for privacy
- Hydraulic steering
- Dual lever hydraulic clutch and throttle controls
- Compass with dimmable light
- Aircraft-type chart light
- Rudder angle indicator
- Control station with all necessary switches and dimmable lighted instruments
- Fuel and water level gauges
- AC distribution panels
- DC distribution panel
- DC electronics panel
- AC switching panel
- 24 and 120 volt light fixtures
- 120 volt duplex outlets
- Telephone outlet
- Ladder and hatch to flying bridge
- Storage cabinets
- Door to galley/dinette
- Stereo speakers

### Flying Bridge and Bridge Deck

- Molded fiberglass bridge
- Storage under control console with 24 volt lighting
- Stainless steel grab rails
- Tinted acrylic windshield
- Control station with all necessary switches and dimmable lighted instruments
- Compass with dimmable light
- Dual lever hydraulic clutch and throttle controls
- Hydraulic steering





#### 60 EXTENDED DECKHOUSE MOTOR YACHT<sup>(A)</sup> Specifications

|                                          |                |           |
|------------------------------------------|----------------|-----------|
| Length Overall <sup>(B)</sup> .....      | 60'9" .....    | 18.52 m   |
| Beam .....                               | 18'2" .....    | 5.54 m    |
| Draft <sup>(C)</sup> .....               | 5'2" .....     | 1.58 m    |
| Freeboard Forward <sup>(C)</sup> .....   | 8'10" .....    | 2.69 m    |
| Freeboard Aft <sup>(C)</sup> .....       | 6'5" .....     | 1.96 m    |
| Headroom Most Areas .....                | 6'7" .....     | 2.01 m    |
| Freshwater Capacity <sup>(C)</sup> ..... | 335 Gals ..... | 1,268 ltr |

|                                                     |                  |           |
|-----------------------------------------------------|------------------|-----------|
| Fuel Capacity <sup>(C)</sup> .....                  | 1,033 Gals ..... | 3,910 ltr |
| Weight Displacement <sup>(C)</sup> .....            | 87,000 Lbs ..... | 39,463 kg |
| Height Above Waterline to                           |                  |           |
| Top of Flying Bridge Windshield <sup>(C)</sup> .... | 18'10" .....     | 5.74 m    |
| Top of Arch <sup>(C)</sup> .....                    | 21'4" .....      | 6.50 m    |
| Twin D.D. 8V-92TA Diesel Engines 720 SHP            |                  |           |
| Twin D.D. 12V-71TA Diesel Engines 870 SHP           |                  |           |

- Helmsman and companion seats, both adjustable
- Rudder angle indicator
- 24 and 120 volt weatherproof receptacles
- Aluminum radar arch
- U-shaped bridge deck seating with vinyl-covered polyfoam cushions and storage
- Bridge ladder and hatch from pilothouse

#### Aft Deck

- 24 volt lighting in hardtop
- Wing boards

#### Salon — Galley

- Wood paneling
- Carpeting (Salon)
- Wood flooring (Galley)
- Vinyl headlining
- Lambrequins with mini blinds and upholstered valance boards
- Door to aft deck
- Entertainment center including 27" stereo color TV, AM/FM stereo receiver, cassette tape deck, VCR; master antenna outlet and master antenna distribution controls
- Dry bar with ice maker and bottle and glass storage
- Tinted safety glass
- Sliding side windows
- 24 and 120 volt light fixtures
- 120 volt duplex outlets
- Stereo speakers
- Telephone outlets
- Stairwell to master stateroom and engine compartment
- Molded countertops
- High pressure laminate storage cabinets, one with damp chaser
- 120 volt refrigerator with freezer and ice maker
- 240 volt four-burner cooktop with oven under counter

- Microwave/convection oven
- Garbage disposal
- Garbage container
- Color-coordinated kitchen sink and faucet
- Dinette with storage under seats
- Dishwasher
- Door to pilothouse

#### Master Stateroom

- Wood paneling
- Carpeting
- Vinyl headlining
- Draperies with upholstered valance boards
- King-sized tapered berth with upholstered headboard and storage under berth
- Polyfoam mattress, spread, pillow shams, pillows, mattress pad, sheets<sup>(E)</sup>
- Ventilating portlights with screens
- Nightstands with drawers
- Walk-in cedar-lined wardrobe with door and automatic light
- Cassette tape player with AM/FM stereo receiver
- Stereo speakers
- 24 and 120 volt light fixtures
- 120 volt duplex outlets
- Telephone outlet
- Built-in dressers, port and starboard
- 13" color TV with MATV outlet

#### Master Head

- Vinyl flooring
- Vinyl headlining
- Vinyl wallcovering
- Molded countertop with sink
- Tub and shower, sliding doors, whirlpool jets and automatic sump pump
- Storage cabinet with sliding mirror
- Towel bars
- Electric toilet
- Exhaust blower
- 24 and 120 volt light fixtures

- 120 volt duplex outlet
- Linen locker

#### Aft Companionway

- Carpet
- Vinyl headlining
- Vinyl wallcovering
- 24 volt light fixtures
- Portable halon fire extinguisher
- Lighted stairway to main salon
- Doors to master stateroom and engine compartment

#### Mid-ship Guest Stateroom (VIP)

- Wood paneling
- Carpeting
- Vinyl headlining
- Draperies with upholstered valance boards
- Queen berth with upholstered headboard and storage underneath
- Polyfoam mattress, spread, pillow shams, pillows, mattress pad and sheets<sup>(E)</sup>
- Ventilating portlights with screens
- Cedar-lined hanging locker with door and automatic light
- Nightstands with drawers
- Full-length mirror
- 24 and 120 volt light fixtures
- 120 volt duplex outlets
- Dresser
- Stereo speakers with volume control
- Telephone outlet
- Private access to head

#### Mid-Ship Guest Head

- Vinyl flooring
- Vinyl wallcovering
- Vinyl headlining
- Frosted ventilating portlight with screen
- Molded countertop with sink



- Stall shower with bi-fold door and automatic sump pump
- Towel bars
- Clothes hamper
- Electric toilet
- Exhaust blower
- Storage cabinet with sliding mirror doors
- 24 and 120 volt light fixtures
- 120 volt duplex outlet

#### Forward Guest Stateroom

- Wood paneling
- Carpeting
- Vinyl headlining
- Draperies with upholstered valance boards
- Twin berths with upholstered headboards and storage underneath
- Polyfoam mattresses, spreads, pillow shams, pillows, mattress pads and sheets<sup>(E)</sup>
- Cedar-lined hanging locker with door and automatic light
- Fixed window
- 24 and 120 volt light fixtures
- 120 volt duplex outlets
- Mirror
- Stereo speakers with volume control

#### Forward Guest Head (Starboard Side)

- Vinyl wallcovering
- Vinyl flooring
- Vinyl headlining
- Stall shower with bi-fold door and automatic sump pump
- Molded countertop with sink
- Storage cabinet
- Mirror
- Towel bars
- Electric toilet
- Exhaust blower
- 24 and 120 volt light fixtures
- 120 volt duplex outlet

#### Bow Stateroom

- Vinyl wallcovering
- Carpeting
- Padded vinyl covering on hullside and vinyl headlining
- Queen-size tapered berth with upholstered headboard and storage underneath
- Polyfoam mattress with spread, pillow shams, pillows, mattress pad and sheets<sup>(E)</sup>
- Dressers, port and starboard
- Mirrored forward bulkhead
- Full-length mirror
- Rope storage locker with divider
- Cedar-lined hanging locker with door and automatic light
- Screened overhead hatch
- Frosted ventilating portlights with screens
- Stereo speakers with volume control
- 24 and 120 volt light fixtures
- 120 volt duplex outlet

#### Forward Companionway

- Carpeting
- Vinyl headlining
- Vinyl wallcovering
- Portable halon fire extinguisher
- Cassette tape player with AM/FM stereo receiver
- Washer/dryer
- Cedar-lined linen locker
- 24 and 120 volt light fixtures
- 120 volt duplex outlet
- Lighted steps to lower companionway
- Lighted stairway to pilothouse
- Doors to guest head, bow stateroom and guest staterooms
- Hatch to machinery compartment

#### OPTIONAL EQUIPMENT<sup>(A)</sup>

##### Base Options

- Twin Berths, Master Stateroom Plan<sup>(F)</sup> .... \$2,385
- Extended Bridge Deck Seating<sup>(F)(G)</sup> ..... 6,330
- Cradle, Heavy Duty ..... 7,945
- Water Delivery Kit<sup>(H)</sup> ..... 1,720

##### Mechanical and Miscellaneous Equipment

- Generator, 20Kw, Add'l. <sup>(D)(F)(I)</sup> ..... 20,520
- Windlass:
  - Model BB ..... 4,675
  - Model BBHW<sup>(J)</sup> ..... 7,645
  - Add'l. Windlass Switch Control BBHW ..... 350
- Anchor, with Chocks, Extra ..... 935
- Stabilizers<sup>(F)</sup> ..... 35,940
- Davit, Low Profile, 1500 Lb, 110 Volt ..... 12,740
- Cradle, Aluminum; on Hardtop for 13' Whaler ..... 3,825
- Sea Ladder with Storage Brackets ..... 1,275
- Dunnage Box, Fiberglass ..... 1,685
- Wash Down, Freshwater, Aft Deck ..... 915
- Wash Down, Freshwater, Foredeck ..... 720
- Wash Down, Seawater, One Outlet ..... 1,930
- Spare Propellers, D.D. 8V-92TA<sup>(K)</sup> ..... P.O.R.
- Main Prop Shaft, D.D. 8V-92TA<sup>(K)</sup> (each) ..... 3,235
- Stub Prop Shaft, D.D. 8V-92TA<sup>(K)</sup> (each) ..... 1,845
- Spare Propellers, D.D. 12V-71TA<sup>(K)</sup> ..... P.O.R.
- Main Prop Shaft, D.D. 12V-71TA<sup>(K)</sup> (each) ..... 3,630

- Stub Prop Shaft, D.D. 12V-71TA<sup>(K)</sup> (each) ..... 1,945
- Combination Intercom/Telephone System ..... 2,675
- Compass Compensation, One ..... 395
- Compass Compensation, Two ..... 460

#### Canvas

- Bimini Top, Folding With Boot ..... 4,240
- Flying Bridge Enclosure, 4 Sides ..... 3,755
- Flying Bridge Enclosure, 3 Sides ..... 2,810
- Flying Bridge Cover ..... 1,425
- Flying Bridge Instrument Cover ..... 245
- Flying Bridge Helmseat Cover (each) ..... 190
- Flying Bridge Lounge Cover ..... 1,145

#### Electrical and Appliances<sup>(F)</sup>

- TV, Multi-standard (in lieu of standard) ..... P.O.R.
- VCR, Multi-standard (in lieu of standard) ..... P.O.R.
- CD Player, Salon<sup>(L)</sup> ..... P.O.R.
- Trash Compactor ..... 1,290
- Central Vacuum System with 3 Outlets ..... 2,675
  - Add'l. Outlet (each) ..... 380
- Telephone Outlet, Add'l. (each) ..... 335
- TV Outlet, Add'l. (each) ..... 450
- Receptacle, Weatherproof, 120V ..... 370
- European Conversion Package, 220v/50Hz ..... P.O.R.
- Docking Lights, Transom (pair) ..... 2,035
- Docking Lights, Bow (pair) ..... 1,840
- Docking Light Switches, Add'l. (each) ..... 360

#### Decor and Furnishings

- Carpeting, Non-Standard Areas:
  - Galley ..... 1,060
  - Head, (each) ..... 225
- Sheets, Add'l., Single Berth<sup>(E)</sup> ..... 95
- Sheets, Add'l., Queen Berth<sup>(E)</sup> ..... 120
- Sheets, Add'l., King Berth<sup>(E)</sup> ..... 145
- Mattress Pad, Add'l., Each Berth ..... 100
- Pillow, Add'l., Dacron Filled ..... 35

#### Paint<sup>(F)</sup>

- Boot Top, Optional Color ..... 390
- Bridge Stripe, Optional Color ..... 615
- Bridge Stripe, Double Colors ..... 1,285

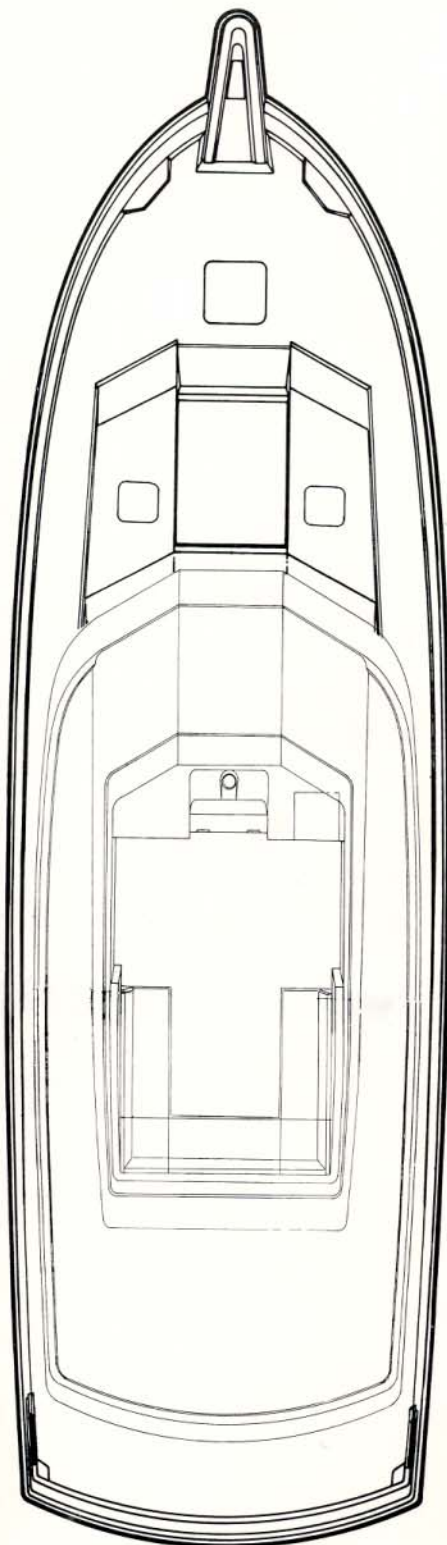

BRIDGE

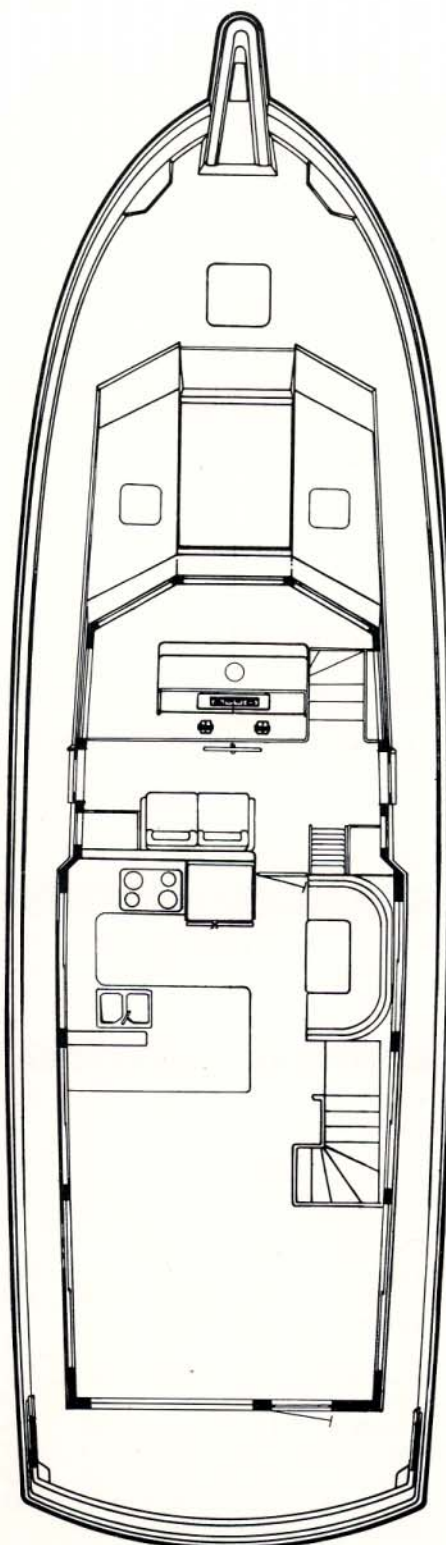

UPPER DECK

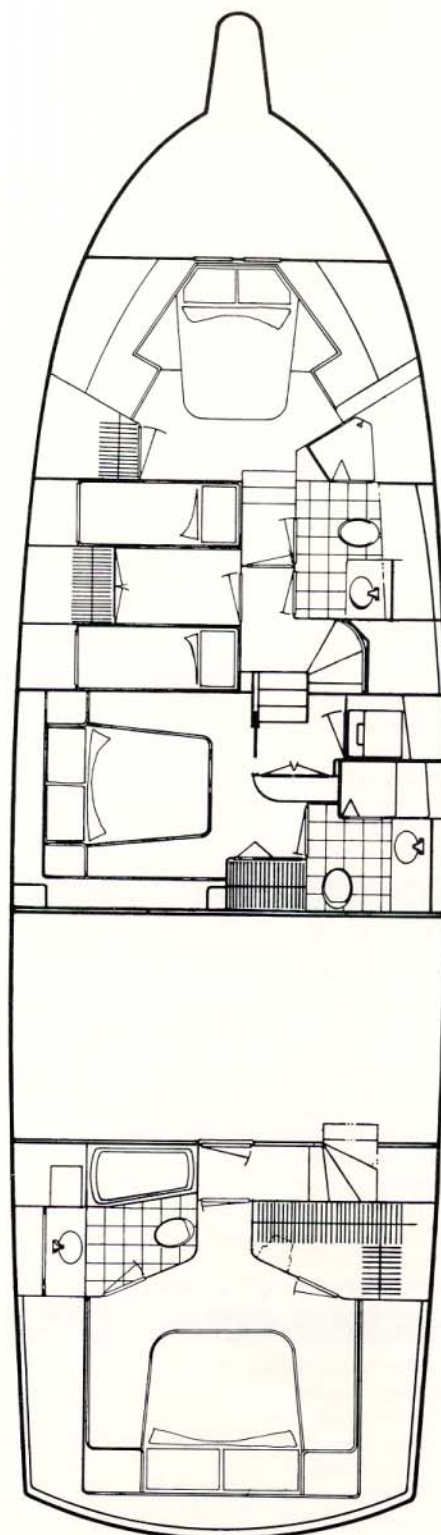

LOWER DECK

60ED



## NOTES TO SPECIFICATIONS AND EQUIPMENT

- (A) Right is reserved to make changes at any time, without notice, in prices, material, specifications and equipment. Orders are accepted subject to prices prevailing at time of shipment. Orders requesting any material and/or equipment which differs from that selected by Hatteras as standard or optional for this model will be considered a custom change and will require additional charges. Prices shown for many options may apply only if ordered prior to start of production. Once production begins, orders for such options may require additional charges due to non-standard installation requirements and/or lead times. In order to show equipment size and location, line drawing may include some optional items. Specifications, standard equipment and optional equipment effective with boats sold at August 1, 1994 through July 31, 1995 Hatteras Base Prices. Prices are quoted in U.S. dollars.
- (B) Length overall does not include the swim platform or bow pulpit.
- (C) Weight, draft, freeboard and height are based on an estimate of model's displacement with largest engines available. Weight is estimated with fuel, holding and freshwater tanks half filled. Draft and freeboard are estimated with all tanks filled. Heights are estimated with all tanks empty. Actual figures will vary depending on production tolerances, equipment, supplies and stores on board, as well as operational and sea conditions. Capacities of tanks are estimated to be total capacity of all tanks normally furnished in this model. Usable capacities will vary depending upon conditions.
- (D) Generator is not intended to supply power to all standard and optional accessories. Load must be limited to generator output rating.
- (E) One set of sheets includes: one bottom sheet, one top sheet, pillowcase(s).
- (F) Option must be ordered prior to start of production. Price shown reflects cost of scheduled installation requirements. A late request for this option will require an additional charge.
- (G) Extended seating eliminates space for dinghy.
- (H) Includes 2 qts. A.T. fluid, 1 case oil, assortment of screws, bulbs and fuses, deck mop and brush, bucket, hose, nozzle, 4 fenders, 1 set filters, belts, impellers and solenoids for main engines, 1 set of filters and impellers for generator(s).
- (I) Includes fuel filters/water separators and oil changing system.
- (J) This model is for use with chain and includes 300 ft. of 3/8" Acculoy chain.
- (K) Storage location and installation not included.
- (L) Depending upon component(s) selected, cabinet may require modification; however, modification may not accommodate all components offered.

## Hatteras Limited Warranty

1. THERE ARE NO EXPRESS WARRANTIES ON PRODUCTS MANUFACTURED BY HATTERAS YACHTS, EXCEPT THAT The Company will, through its selling Dealer, replace or repair, at the Company's option, any part (except as hereinafter provided) which is proven to its satisfaction to have been defective at the time of delivery to the first owner, and which defect is discovered within twelve months from the date of delivery to the first owner, if the part is returned, transportation prepaid, within thirty days after the defect is discovered, to the Dealer or to such other point of manufacture as the Company may designate.

In addition, the Company will, through its selling dealer, repair any hull which is proven to its satisfaction to have been defective at the time of delivery to its first owner and which defect is discovered and reported within (5) years from the date of delivery to the first owner.

2. This warranty shall not apply to:

- (a) The cost of removal or reinstallation of part, or disassembly or reassembly of the unit of which it is a component.
- (b) Varnishes, gelcoats, paints, fabrics, chromium plated and stainless steel finishes, because of the varying effect resulting from different climatic and use conditions.
- (c) Products not of the Company's manufacture. Any warranty provided by the manufacturer will be passed on to the owner if possible.
- (d) The installation of any equipment by a Dealer or other installer.
- (e) Racing boats or engines.
- (f) Speeds, fuel consumption and other performance characteristics because they are estimated and not guaranteed.
- (g) Conditions resulting from misuse, abuse, negligence, alteration or lack of performance of normal maintenance.
- (h) Others than the first owner.
- (i) Boats that are used in commercial, charter, or military activities.

3. THE WARRANTY PROVISIONS SET FORTH ABOVE ARE EXCLUSIVE AND ARE IN LIEU OF, AND COMPANY DISCLAIMS, ANY AND ALL OTHER WARRANTIES, EXPRESS, IMPLIED OR STATUTORY, WHATSOEVER INCLUDING, WITHOUT LIMITATION, ANY IMPLIED WARRANTIES UNDER THE UNIFORM COMMERCIAL CODE, ANY IMPLIED WARRANTY OF MERCHANTABILITY AND ANY IMPLIED WARRANTY OF FITNESS FOR A PARTICULAR PURPOSE. THE REPLACEMENT OR REPAIR OF DEFECTIVE PARTS AS STATED ABOVE IN THIS WARRANTY SHALL BE THE SOLE AND EXCLUSIVE REMEDY OF ANY PERSON AND SHALL BE THE SOLE LIABILITY OF THE DEALER AND THE COMPANY UNDER THIS WARRANTY AND ANY IMPLIED WARRANTIES WHICH ARE NOT DISCLAIMED HEREIN. THE COMPANY OR ITS DEALER SHALL NOT BE LIABLE UNDER ANY CIRCUMSTANCES FOR LOSS OF TIME, INCONVENIENCE, LOSS OF USE, OR FOR ANY OTHER INCIDENTAL, SPECIAL, CONSEQUENTIAL OR INDIRECT DAMAGES.

Some states do not allow limitations on implied warranties or in the exclusion of incidental or consequential damages, so the above limitation on the exclusion of implied warranties and exclusion on incidental and consequential damages may not apply.

4. THIS WARRANTY IS EXPRESSLY IN LIEU OF ANY NON-CONTRACTUAL LIABILITIES, INCLUDING PRODUCT LIABILITIES BASED UPON NEGLIGENCE OR STRICT LIABILITY.
5. THE DEALER IS NOT THE AGENT OF HATTERAS YACHTS. The Company does not authorize the Dealer, or any other person, to assume for the Company any liability in connection herewith or any liability or expense incurred in the repairing of its products other than those expressly authorized herein. THE DEALER MAY NOT EXTEND, OR IN ANY WAY CHANGE OR AMEND, THIS EXPRESS WARRANTY.
6. The Company reserves the right to improve its products through changes in design or material without being obligated to incorporate such changes in products of prior manufacture.
7. You may secure performance of warranty obligations hereunder by:
- (a) Oral or written communication with the Hatteras Dealer from which you purchased the boat, making an appointment to have the Dealer examine your Hatteras boat.
  - (b) Delivering your Hatteras boat to the selling Hatteras Dealer for his examination.
  - (c) In certain cases the Dealer is authorized to complete Hatteras Limited Warranty obligations unilaterally, and in others he must receive authorization from the Hatteras Service Department. The Dealer is obliged to follow whichever course is appropriate.
  - (d) Upon completion of Hatteras Limited Warranty obligations, the Dealer will notify you of the availability of your Hatteras boat for your pickup.
  - (e) Major mechanical components, such as engines, generator sets, electronics, appliances, and air conditioning, for example, are warranted by the manufacturer of the component. They have authorized service dealers in most major boating markets. Your Hatteras Dealer will identify such service dealers upon request.
8. Any other communications necessary in connection with this warranty should be sent to the following address:

HATTERAS YACHTS  
Attention: Director of Service  
2100 Kivett Drive P.O. Box 2690  
High Point, North Carolina 27261

9. THIS WARRANTY GIVES YOU SPECIFIC LEGAL RIGHTS, AND YOU MAY ALSO HAVE OTHER RIGHTS WHICH VARY FROM STATE TO STATE.

**Hatteras®**  
The World's Premier Yacht Builder

Hatteras Yachts  
2100 Kivett Drive, P.O. Box 2690  
High Point, NC 27261 U.S.A.  
(910) 889-6621