



AMF
Hatteras

65 Long Range Cruiser



Magnificent main-deck salon (looking aft). Offers expansive living area rich in natural woods and plush carpeting. Tinted side windows allow a panoramic view.



Optional salon/aft deck arrangement extends your living area. Salon is completely open to enclosed aft deck that includes air conditioning (and heating) controlled by a separate thermostat.

Main-deck salon (looking forward). Quiet air-conditioning (and heating) and built-in entertainment center with AM/FM stereo cassette tape player offer relaxing comfort in any climate. Opens to galley and through to pilot house.



The ports of the world are open to you in the Hatteras 65 Long Range Cruiser.

Whether confidently cruising the crystal seas of the Bahamas. Or luxuriously moored in the warm waters of the southern Mediterranean.

From wherever you embark, you'll discover a world of reasons to expand your horizons into a Hatteras 65 Long Range Cruiser.

It begins with an expertly-designed full-displacement hull.

Seakindly. To keep you more comfortable in rough going.

Efficient. To allow the twin G.M. 6-71N diesels to power you to any of your favorite ports within up to a 3,000 mile cruising range.

And with a wealth of space that permits the Hatteras 65 to offer you spacious and luxurious accommodations nothing short of magnificent in any language.

The Hatteras 65 Long Range Cruiser. Quality that needs neither explanation nor translation. Wherever your favorite port may be.



Complete galley features four-burner range and eye-level oven, full-size refrigerator/freezer with ice maker, dishwasher, stainless steel sinks with disposal, variable-speed blender and counter and storage space.



Top:

Double doors from the salon open to the spacious aft deck with sliding wing board windows, doors to the side decks and access door to the aft cockpit. Also, a wet bar with ice maker. Enclosed aft deck is available.

Enclosed pilot house includes convenient overhead electronics area and ample chart storage. An optional arrangement features a spacious dinette aft of the helm with a bulkhead pass-through to the galley. Sliding doors open to the walk-around side decks.

The master head offers a full-length vanity counter, sliding mirror, toiletries and linen storage and an exhaust blower.

The master head also features a full-size tub with shower.



Luxury in any language.

Nowhere is the magnificent luxury of the Hatteras 65 more evident than in the private master suite—your personal world of luxury below decks.

Accessible by a private stairwell from the salon, the full-beam master stateroom is richly appointed with built-in furniture of natural woods.

The standard walk-around queen berth, twin nightstands and generous drawer space in the large dressers affords the amenities that let you feel comfortably at home.

While twin, cedar-lined hanging lockers invite you to bring your most extensive cruising wardrobe.

An optional layout offers these same impressive features, but with a twin-berth to starboard and double-berth to port.

And the private master head is complete with all the niceties, including a full-size tub with shower.

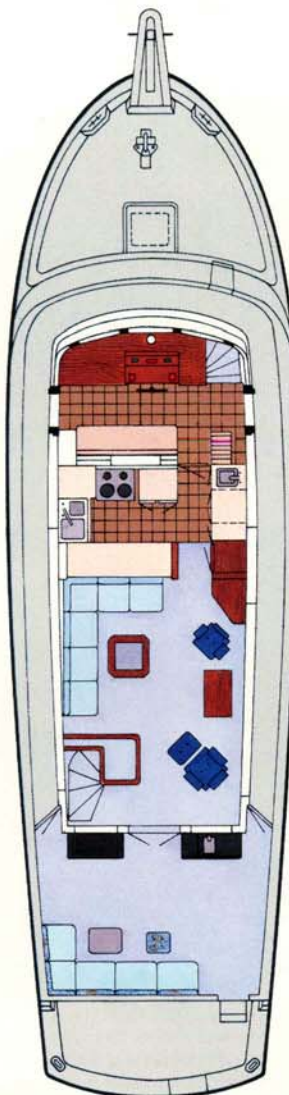

Standard deckhouse arrangement

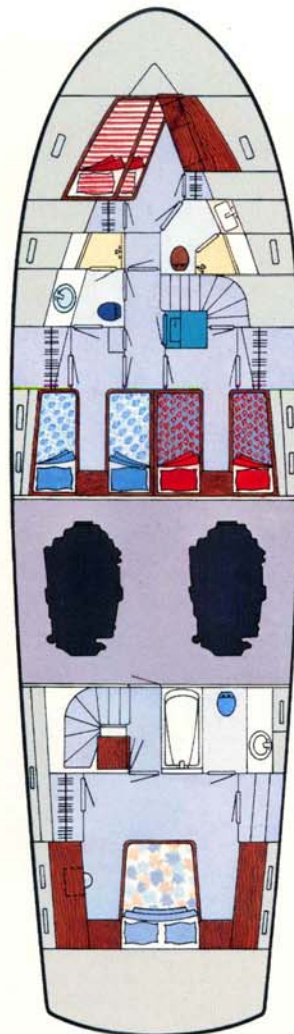

Standard lower deck arrangement



Master stateroom with walk-around queen berth. Generous drawer and locker space. Plush carpeting throughout.



Master stateroom extras include a separate thermostat control for air-conditioning (and heating), as well as an individual volume control for the stereo speakers. Companionway houses optional freezers.



Starborad guest stateroom offers plenty of guest comfort, including a separate thermostat control for air-conditioning and heating.

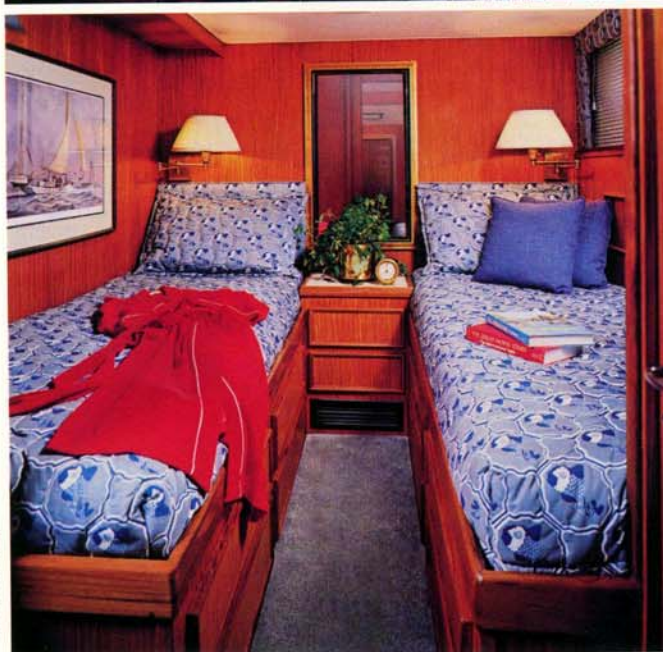

Port guest stateroom with twin berths and ample drawer and locker space. Extras include volume control for the stereo speakers, plus convenient access to the guest head.



Guest head is complete with stall shower. Plenty of storage for towels and toiletries. A fitting companion to luxurious guest staterooms.



Bow stateroom provides additional guest or crew comfort, including a private head with shower.



The engine room. Truly a design achievement with ample room for the wealth of Hatteras systems and features.

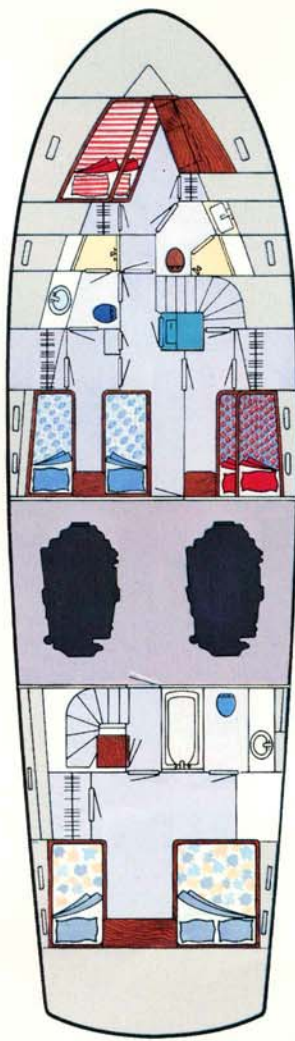
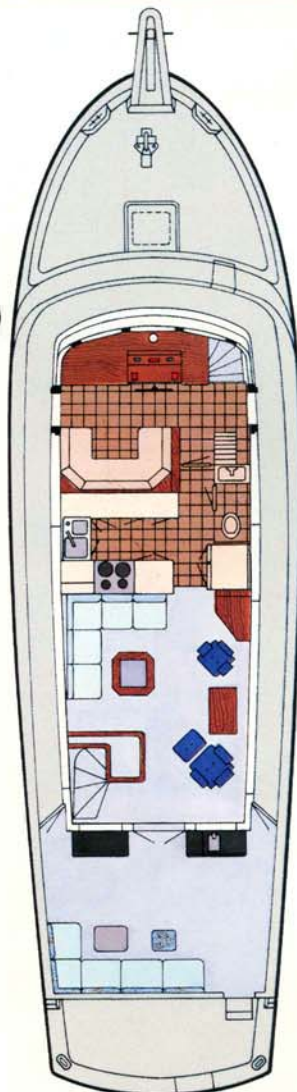

Optional deckhouse arrangement Optional lower deck arrangement

Luxury awaits your guests.

The luxury of the 65 Long Range Cruiser is extended to your guest in comfortable accommodations tastefully complete. And sure to impress.

Two private guest staterooms each offer twin berths with storage drawers under, a nightstand and a lighted hanging locker.

The guest head has a mirrored vanity counter and a large stall shower. It also opens to the forward companionway for convenient use during the day.

The private bow stateroom accords additional guest or crew comfort with upper and lower berths to port, built-in dresser with drawers, two hanging lockers and a private head with stall shower.

The forward companionway has its extras, too. Such as a full-length hanging locker, a shelved linen locker and an additional locker sized for an optional washer/dryer. Hatteras comfort for you.



AMF

Hatteras Yachts

High Point, North Carolina 27261 U.S.A.

65LRC 7.5 0982
Printed in U.S.A.

AMF Hatteras Yachts reserves the right to make styling, design, equipment and construction changes without notice. Also, prices are subject to change without notice. Some items shown may be optional. Hatteras is a registered trademark of AMF Incorporated. © 1982 AMF Incorporated