



AMF
Hatteras

65 Long Range Cruiser

Hatteras Proudly Presents The Sixty-Five Long Range Cruiser

SPECIFICATIONS

Engines	Twin G.M. 6-71N diesels	
Length Over All	65'0"	19.81 m
Beam	17'11"	5.46 m
Draft	4'10"	1.47 m
Freeboard Forward	9'10"	3.00 m
Freeboard Aft	6'7"	2.00 m
Headroom Most Areas	6'7"	2.00 m
Fresh Water Capacity	448 gals (est).....	1,696 ltr (est)
Fuel Capacity	2,689 gals (est).....	10,179 ltr (est)
Weight Displacement	105,000 lbs (est).....	47,628 kg (est)
Height Above Waterline Mast Up	26'0"	7.93 m

Our years of experience designing and constructing the world's best production full-displacement vessels are reflected in every aspect of the 65 Long Range Cruiser from Hatteras. It's a sea-going cruiser designed to provide live-aboard comfort for extended cruising of up to 3,000 miles with the fuel efficiency required for long passages.

Powered by dependable twin G.M. 6-71N diesels the 65'0" full-displacement fiberglass cruiser — with its 17'11" beam — offers a selection of above and below deck arrangements to satisfy a variety of individual tastes and cruising requirements.

Accommodations include an enclosed pilot house, main deck galley with dining counter, large salon, crew stateroom, two guest staterooms, large private master suite, three heads, and a full beam walk-in engine room. An optional pilot house arrangement features dinette seating and is opened to the galley by a bulkhead pass-through. A main deck day head is also available.

The **pilot house** features a complete control station, lounge seat for three, foul weather gear locker, ample chart storage, and a convenient overhead electronics area. There are also side deck access doors, teak flooring, AC and DC distribution panels for the Hatteras state-of-the-art electrical system. A ladder to the flying bridge and bridge deck area is also standard. The

optional pilot house arrangement offers the same features of the standard arrangement but also includes a spacious dinette aft of the helm. A functional bulkhead pass-through offers convenient access to the modern galley.

Aft of the pilot house on the main deck is the fully-equipped **galley** that features side-by-side refrigerator/freezer with ice maker, a four-burner range with eye level oven, a full-size dishwasher and a variable speed blender. A double stainless steel sink plus a garbage disposal provide for easy cleanup. There is a generous serving counter aft.

Starboard of the galley are wood cabinets and a wet bar. Here also is space for an optional **day head**.

The large carpeted **salon** opens to the spacious aft deck through double doors and offers such standard features as AM/FM stereo radio, valance boards with draperies, 32,000 BTU air conditioning with thermostatic control and ventilating side windows of tinted safety glass. Double doors open to the side-enclosed **aft deck** which features wing doors port and starboard, a wet bar with ice maker and ventilating wing board windows. A completely enclosed aft deck with heating and air conditioning is available. Steps lead from the aft deck to the molded fiberglass **cockpit** with standard transom gate.

The below deck stateroom arrangement offers a total sleeping capacity for

eight. The **bow stateroom** has over and under berths, a built-in dresser and two hanging lockers as well as a private head with shower. Also forward are two **guest staterooms** with complete head and stall shower.

The **master stateroom** aft, accessible by private stairway from the salon, features a queen-size berth and built-in nightstands, large dresser, vanity with makeup lights and cedar lined hanging locker. Like the other staterooms there is air conditioning with separate thermostats, stereo speakers, carpeting and draperies for additional comfort. The master head has its own full-size tub with shower.

Located in the **forward companionway** is a linen locker and a standard hanging locker sized for an optional washer/dryer.

The private **aft companionway** is paneled with natural wood and offers a hanging locker sized for optional freezers and a door to the stand-up **engine room**.

Advanced marine safety and engineering features include a 12-point systems monitor with visual and audible alarm for critical functions. A 20-KW generator is standard and a second 20-KW generator is optional. Other features include 120/240V transformer connected shorelines, an engine-driven emergency bilge pump and an automatic engine room fire extinguishing system.

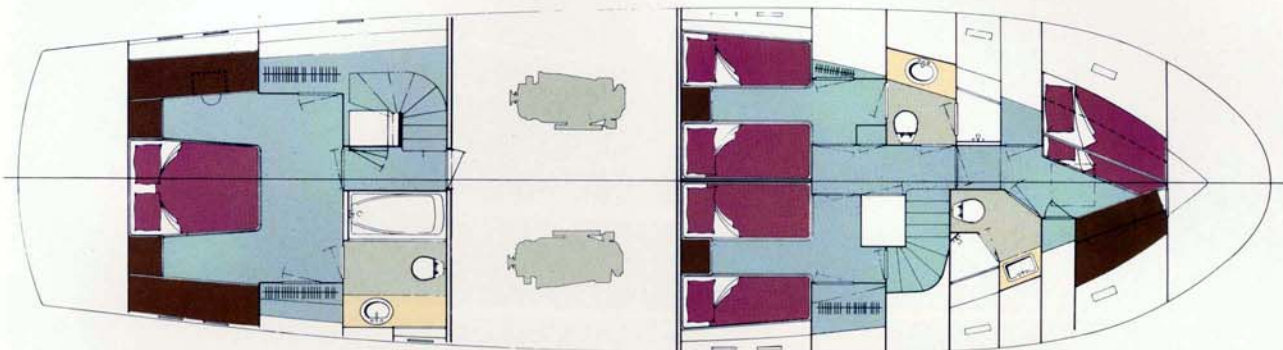
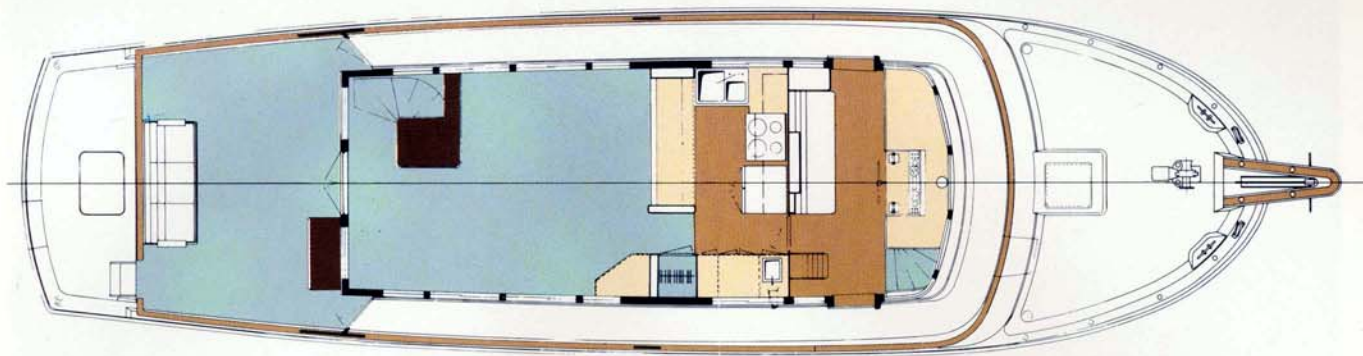

STANDARD MAIN AND LOWER DECK ARRANGEMENTS

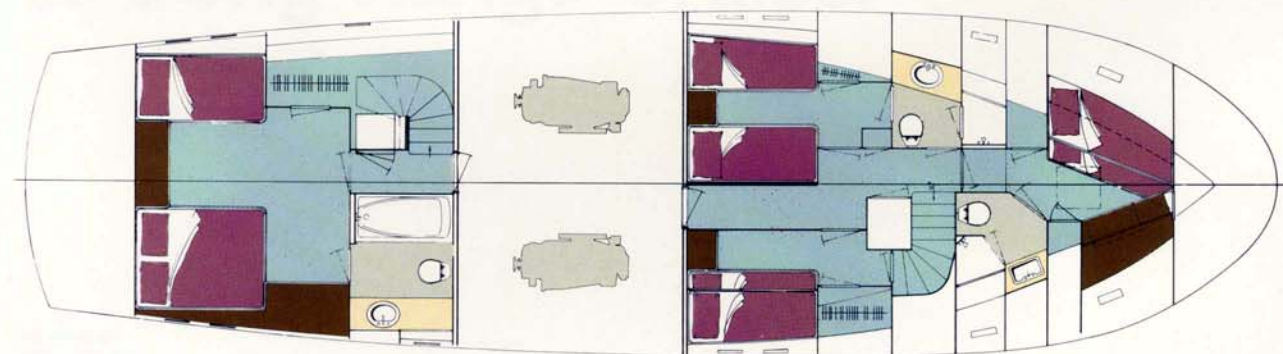
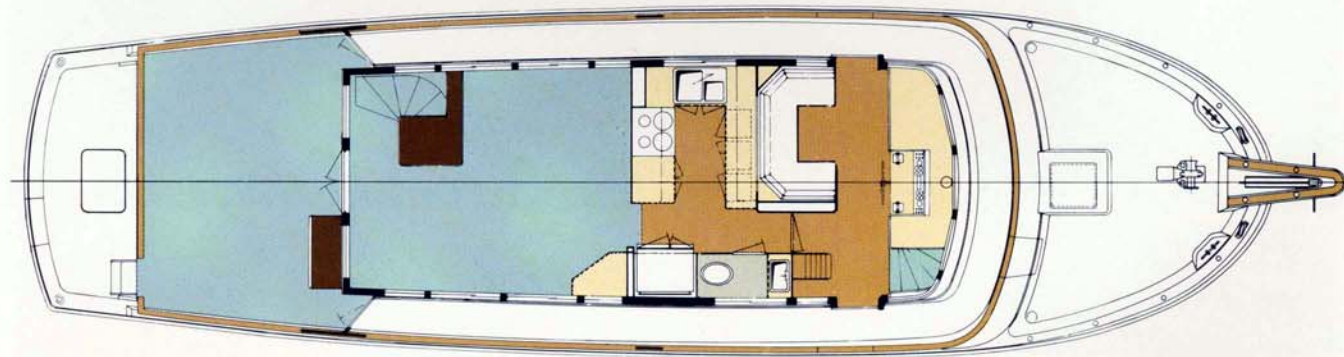

OPTIONAL MAIN AND LOWER DECK ARRANGEMENTS



AMF

Hatteras Yachts
High Point, North Carolina 27261

65LRC5M1181
Printed in U.S.A.

AMF Hatteras Yachts reserves the right to make styling, design, equipment and construction changes without notice. Also, prices are subject to change without notice. Some items shown may be optional.
Hatteras is a registered trademark of AMF, Incorporated. ©1981 AMF Incorporated